

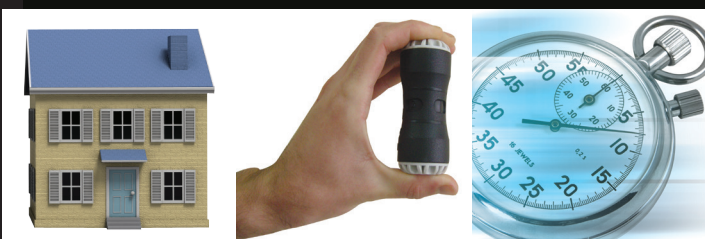

# EFAS

## Plasson Serie 1

Den nye kompakte koblingen



Teknisk katalog

2015

Global Presence - Local Commitment



**PLASSON**<sup>®</sup>

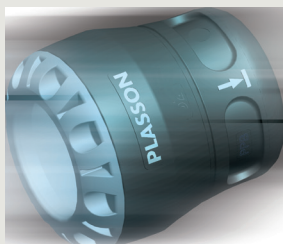

Plasson Serie 1 - Den nye innovative serien med koblinger fra Plasson, markedsleder innen plastkoblinger for rørsystemer i PE.

Plasson Serie 1 - Koblingene gir mulighet for å koble PE rør til andre typer materiale slik som kobber, polybutylene, PVC og PEX.

Plasson Serie 1 - Koblingene er designet for max 16 bar driftstrykk. Ved å føre røret inn til stopp punktet har man oppnådd både en strekkfast og tett kobling.

Plasson Serie 1 - Med sitt kompakte og attraktive design er koblingene ideelle for rørleggere, blant annet når begrenset plass er avgjørende. Den enkle monteringen gjør at både profesjonelle og de som ikke bruker koblingene så ofte får en enklere jobb, samtidig beholder man påliteligheten til Plasson koblingen.

Kombinasjonen av Plasson's nåværende utvalg og den nye Serie 1 oppfylder markedets krav hvor PE rør kobles mot andre typer rørmaterialer.

Plasson Serie 1 gir mange muligheter og fordeler:

- Estetisk høyverdige produkter - profesjonelt utseende
- Ingen verktøy er nødvendig for montering - enkel "push fit" montering
- Kompakte deler - gjør det enklere å montere når plass er en begrensning
- Koblingen tetter umiddelbart - maksimal pålitelighet
- Integrert pakning i pakningsspor - ingen muttere å stramme
- 100 % strekkfast kobling
- Overgang fra PE utendørs til innendørs rørsystemer - kobber, PB, PVC og PEX tilpasset i en kobling
- Designet for å holde i minimum 50 år - gir påliteligheten du trenger som rørlegger og fagmann
- Kompakte koblinger gir mindre krav til lagerplass

## Tekniske spesifikasjoner

### Materialer

#### Koblinger

Kropp: Polypropylen

Mutter: Polypropylen

Split ring og gripe ring: Acetal (POM)

Støttehylse: Acetal (POM)

Pakning: Nitril gummi (NBR)

Forsterkende Ring: Rustfri stål ring som utvendig forsterkning på alle koblinger med innvendige gjenger 1¼" til 2"

#### Gjengede koblinger

Kropp: Polypropylen

Forsterkende ring: Rustfritt stål

Messing gjenger: DZR, avsinkningsfri messing

### Temperaturer

Koblingene skal ikke brukes i varmtvanns-applikasjoner. Koblingen tåler minusgrader.

### Kjemisk motstand

Plasson Serie1 koblinger kommer med polyacetal split - og gripe ringer som standard samt NBR pakninger som er egnet for vann.

### Trykk og sertifikater

Plasson deler/koblinger fra 20-63mm er testet og godkjent i følge ISO 14236 opp til PN16. Serie 1 innehar produktgodkjenning fra Sintef.



### Gjenger

Alle gjenger samsvarer med ISO-7/1, BS 21, DIN 2999, NEN 3258, AS 1722 Del 1.

Alle utvendige gjenger er koniske.

Alle innvendige gjenger er parallelle.

### Forkortelser

AP	Antall i pose
AK	Antall i kartong
V	Vekt i gram
	Tilgjengelig i løpet av 2015

### Generell informasjon

Før installasjon, vær sikker på at enden på røret som skal inn i koblingen ikke er ripete eller på andre måter ødelagt, og at røret og rigg/jigg er fri for sand, søle og steiner etc. Hvis man gjenbraker koblingene så må man være sikker på at tennene på split - og gripe ringen er inntakte og at tennene er "skarpe" slik at de "biter" på røret, dette for å hindre at rørene blir dratt ut av koblingene.

Vi vil sterkt anbefale å bruke PTFE tape på gjengekoblinger. For diameter 40mm og større, vil fasing og smøring av røret gjøre at det blir enklere å sette inn røret (bruk silikonbasert smøring).

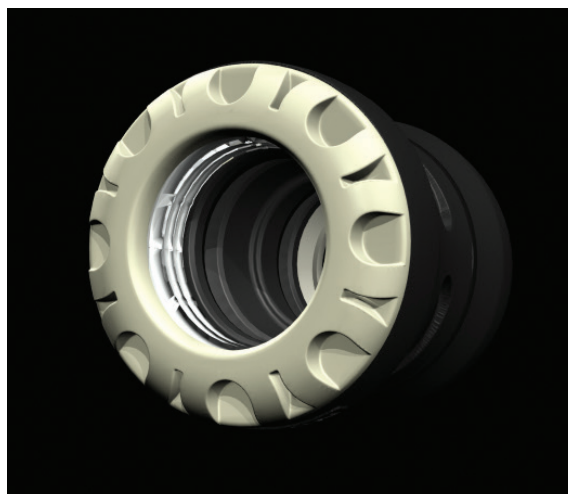

## Serie.1 Union

PL-1001

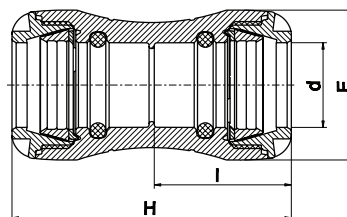

Varenummer	NRF	d	E	H	l	AP	AK	V
PL-100100020	2446501	20	41	92	45	1	260	64
PL-100100025	2446502	25	47	98	48	1	200	80
PL-100100032	2446503	32	58	108	53	1	140	126
PL-100100040	2446504	40	70	142	70	1	90	234
PL-100100050	2446505	50	85	158	78	1	55	369
PL-100100063	2446506	63	103	183	90	1	30	620

## Serie.1 Union reduksjon

PL-1011

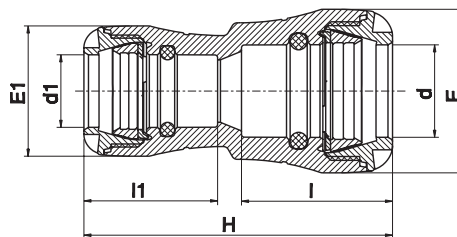

Varenummer	NRF	d x d1	E	H	l	E1	l1	AP	AK	V
PL-101100025020	2446561	25 x 20	47	100	48	41	45	1	200	75
PL-101100032020	2446562	32 x 20	58	106	54	41	45	1	160	95
PL-101100032025	2446563	32 x 25	58	110	54	47	48	1	160	109
PL-101100040032	—	40 x 32	70	139	71	58	55	1	100	196
PL-101100050025	—	50 x 25	85	151	79	47	46	1	80	262
PL-101100050032	—	50 x 32	85	151	79	58	55	1	75	285
PL-101100050040	—	50 x 40	85	165	77	58	53	—	—	—
PL-101100063032	—	63 x 32	103	170	91	58	55	1	—	—
PL-101100063040	—	63 x 40	103	184	91	70	72	1	40	485
PL-101100063050	—	63 x 50	103	187	91	85	81	1	35	542

## Serie.1 Reperasjonskobling

PL-1761

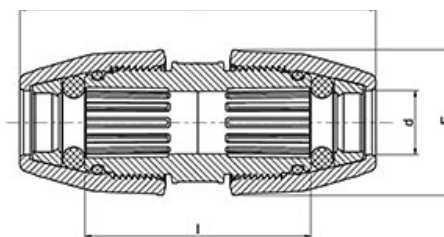

Varenummer	NRF	d x d	E	H	l	AP	AK	V
PL-176100025	—	25	60	150	94	5	—	—
PL-176100032	—	32	68	160	96	5	—	—

Serie.1 Endekappe

PL-1012

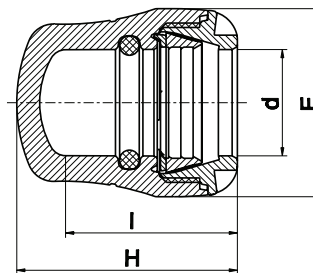

Varenummer	NRF	d	E	H	I	AP	AK	V
PL-10120020	2446564	20	41	56	45	1	360	39
PL-10120025	2446565	25	47	60	48	1	300	50
PL-10120032	2446566	32	58	68	53	1	240	82
PL-10120050	2446567	40	70	90	71	1	150	146
PL-10120050	2446568	50	85	102	79	1	100	229
PL-10120063	2446569	63	103	117	91	1	55	379

Serie.1 Tippunion utv. gjenger

PL-1002

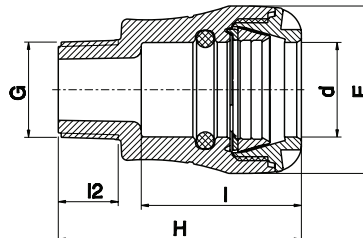

Varenummer	NRF	d X G	E	H	I	l <sub>2</sub>	AP	AK	V
PL-100200020005	2446512	20 x 1/2"	41	70	45	16	1	340	41
PL-100200020007	2446513	20 x 3/4"	41	71	45	17	1	300	41
PL-100200025005	2446514	25 x 1/2"	47	75	48	16	1	300	52
PL-100200025007	2446515	25 x 3/4"	47	76	48	17	1	300	52
PL-100200025010	2446516	25 x 1"	47	78	48	19	1	280	55
PL-100200032007	2446517	32 x 3/4"	58	82	55	17	1	230	83
PL-100200032010	2446518	32 x 1"	58	84	55	19	1	220	86
PL-100200032013	2446519	32 x 1 1/4"	58	86	55	21	1	200	90
PL-100200032015	2446521	32 x 1 1/2"	58	86	55	21	1	200	94
PL-100200032020	—	32 x 2"	58	97	55	25	5	140	138
PL-100200040010	2446522	40 x 1"	70	104	73	19	1	140	145
PL-100200040013	2446523	40 x 1 1/4"	70	106	73	21	1	135	149
PL-100200040015	2446524	40 x 1 1/2"	70	106	73	21	1	130	152
PL-100200050010	—	50 x 1"	85	125	78	21	1	90	231
PL-100200050013	—	50 x 1 1/4"	85	122	78	21	1	90	231
PL-100200050015	2446525	50 x 1 1/2"	85	114	81	21	1	90	226
PL-100200050020	2446526	50 x 2"	85	118	81	25	1	85	232
PL-100200063015	2446527	63 x 1 1/2"	103	125	92	19	1	50	377

## Serie.1 Tippunion innv. gjenger

PL-1003

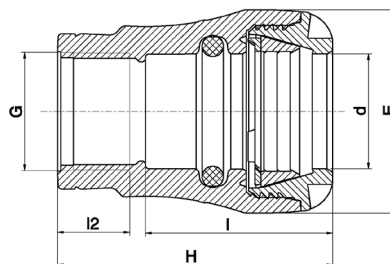

Varenummer	NRF	d x G	E	H	I	l2	AP	AK	V
PL-100300020005	2446529	20 x 1/2"	41	67	45	17	1	340	43
PL-100300020007	2446531	20 x 3/4"	41	71	45	18	1	320	45
PL-100300025005	2446532	25 x 1/2"	47	7	48	17	1	300	52
PL-100300025007	2446533	25 x 3/4"	47	71	48	18	1	280	52
PL-100300025010	2446534	25 x 1"	47	80	48	21	1	280	60
PL-100300032007	2446535	32 x 3/4"	58	77	54	18	1	200	78
PL-100300032010	2446536	32 x 1"	58	79	54	21	1	200	81
PL-100300032013	2446537	32 x 1 1/4"	58	90	54	24	1	160	112
PL-100300040010	2446538	40 x 1"	70	97	70	21	1	140	153
PL-100300040013	2446539	40 x 1 1/4"	70	100	70	24	1	135	171
PL-100300040015	2446541	40 x 1 1/2"	70	103	70	24	1	130	171
PL-100300050013	2446542	50 x 1 1/4"	85	110	78	24	1	90	241
PL-100300050015	2446543	50 x 1 1/2"	85	110	78	24	1	90	247
PL-100300050020	2446544	50 x 2"	85	118	78	29	1	80	252
PL-100300060015	2446545	63 x 1 1/2"	103	125	90	24	1	50	378
PL-100300060020	2446546	63 x 2"	103	129	90	29	1	45	379

## Serie.1 Union PE/Kobber

PL-1001C

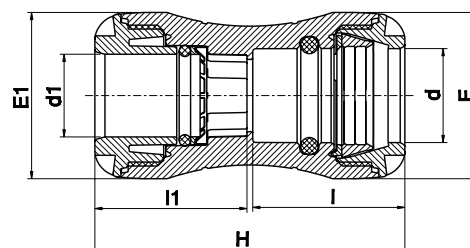

Varenummer	NRF	d x d1	E	H	I	E1	l1	AP	AK	V
PL-1001C0020015	2446507	20 x 15	41	92	45	41	46	5	260	68
PL-1001C0025015	2446508	25 x 15	47	100	48	41	46	5	200	79
PL-1001C0025022	2446509	25 x 22	47	98	48	47	48	5	180	81
PL-1001C0032028	2446511	32 x 28	58	108	53	58	53	5	120	131
PL-1001C0040028	—	40 x 28	70	139	71	58	55	1	120	203

Serie.1 Tippunion utv. gj. kobber

PL-1002C

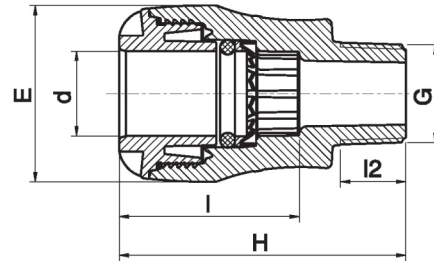

Varenummer	NRF	d x G	E	H	I	l2	AP	AK	V
PL-1002C7015007	—	15 x 3/4"	41	71	45	17	1	300	47
PL-1002C7022007	—	22 x 3/4"	47	76	48	17	1	300	51
PL-1002C7028010	—	28 x 1"	58	84	55	19	1	180	91

Serie.1 Tippunion innv. gj. kobber

PL-1003C

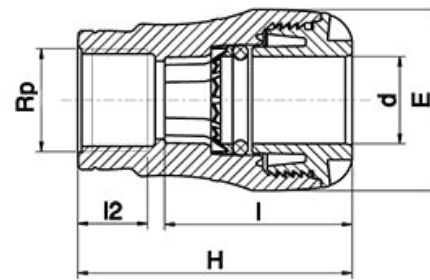

Varenummer	NRF	d x G	E	H	I	l2	AP	AK	V
PL-1003C7015007	—	15 x 3/4"	41	71	45	18	1	300	48
PL-1003C7022007	—	22 x 3/4"	47	71	48	18	1	280	55

Serie.1 Union universal

PL-10017

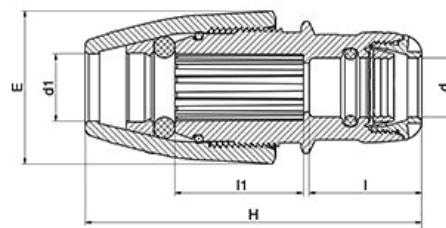

Varenummer	NRF	d x d1	E	H	I	l1	AP	AK	V
PL-100170025018	—	25 x 14-18	54	117 - 137	48	47	5	180	130
PL-100170025022	—	25 x 19-22	57	119 - 130	48	47	5	150	141
PL-100170025028	—	25 x 24-28	66	130 - 142	48	55	5	120	180

## Serie.1 Union PE/PVC

## PL-1001Q

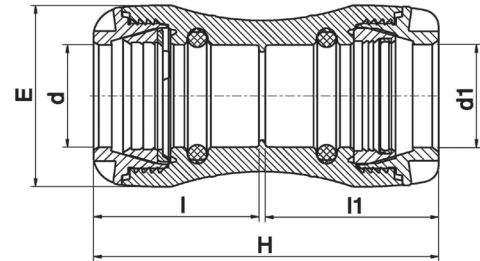

Varenummer	NRF	dxd1*	H	E	I	I1	AP	AK	V
PL-1001Q0025	—	25x25	100	47	48	50	1	160	85
PL-1001Q0032	—	32x32	110	58	53	55	1	100	133
PL-1001Q0040	—	40x40	145	70	70	73	1	100	249

d1-PVC kobling\*

## Serie.1 Union PVC/PVC

## PL-1001QQ

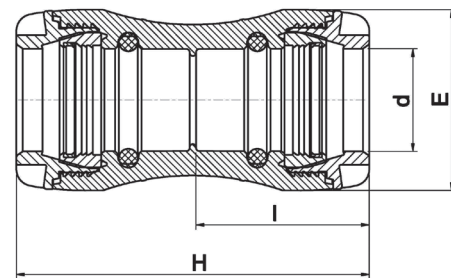

Varenummer	NRF	d	H	E	I	AB	AK	V
PL-1001QQ025	—	25	101	47	50	1	160	95
PL-1001QQ032	—	32	112	58	55	1	100	144
PL-1001QQ040	—	40	148	70	73	1	80	262

## Serie.1 Union metrisk til tommer

## PL-1001M

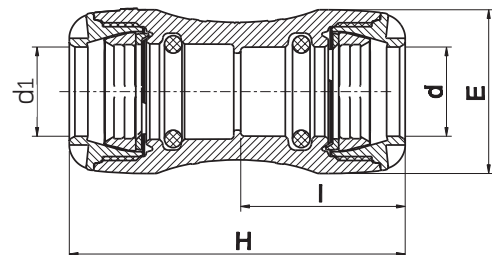

Varenummer	NRF	d x d1	E	H	I	AP	AK	V
PL-1001M6020005	—	20 x 1/2"	41	92	45	1	240	62
PL-1001M6025005	—	25 x 1/2"	47	100	48	1	240	76
PL-1001M6025007	—	25 x 3/4"	47	98	48	1	200	80
PL-1001M6032010	—	32 x 1"	58	108	53	1	120	130



Serie.1 Tippunion PE/Messing utvendig gjenger

PL-1072

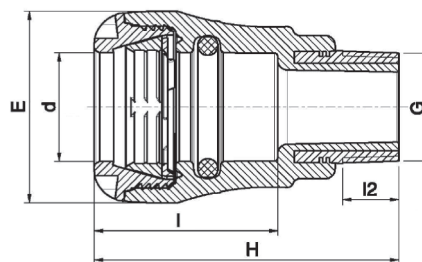

Varenummer	NRF	d	E	H	I	l2	AP	AK	V
PL-107200020005	2446571	20 x ½"	41	76	45	13	1	340	72
PL-107200020007	2446572	20 x ¾"	41	77	45	15	1	300	82
PL-107200025005	2446573	25 x ½"	47	79	48	13	1	290	82
PL-107200025007	2446574	25 x ¾"	47	80	48	15	1	300	92
PL-107200025010	2446575	25 x 1"	47	85	48	17	1	240	126
PL-107200032007	2446576	32 x ¾"	58	88	55	15	1	200	120
PL-107200032010	2446577	32 x 1"	58	92	55	17	1	170	153
PL-107200032013	2446578	32 x 1¼"	58	100	55	19	1	140	200
PL-107200032015	—	32 x 1½"	58	101	55	19	1	140	239
PL-107200040010	2446579	40 x 1"	70	110	73	17	1	130	216
PL-107200040013	2446581	40 x 1¼"	70	113	73	19	1	110	260
PL-107200040015	2446582	40 x 1½"	70	113	73	19	1	100	290
PL-107200050010	—	50 x 1"	85	127	81	17	1	—	—
PL-107200050013	—	50 x 1¼"	85	127	81	19	1	—	—
PL-107200050015	2446583	50 x 1½"	85	120	81	19	1	80	366
PL-107200050020	2446584	50 x 2"	85	127	81	23	1	65	449
PL-107200063015	2446585	63 x 1½"	103	132	92	19	1	50	500
PL-107200063020	2446586	63 x 2"	103	139	92	23	1	50	580

## Serie.1 Tippunion PE/Messing innvendig gjenger

PL-1073

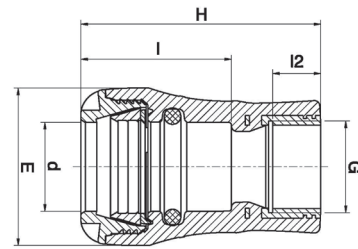

Varenummer	NRF	d x G	E	H	I	l2	AP	AK	V
PL-107300020005	2446587	20 x 1/2"	41	73	45	15	1	300	81
PL-107300020007	2446588	20 x 3/4"	41	80	45	16	1	280	100
PL-107300025005	2446589	25 x 1/2"	47	76	48	15	1	290	91
PL-107300025007	2446591	25 x 3/4"	47	78	48	16	1	300	104
PL-107300025010	2446592	25 x 1"	47	89	48	19	1	200	136
PL-107300032007	2446593	32 x 3/4"	58	86	56	16	1	180	135
PL-107300032010	2446594	32 x 1"	58	88	56	19	1	170	158
PL-107300032013	2446595	32 x 1 1/4"	58	98	56	21	1	120	214
PL-107300040007	—	40 x 3/4"	70	109	73	16	1	130	201
PL-107300040010	2446596	40 x 1"	70	106	73	19	1	130	231
PL-107300040013	2446597	40 x 1 1/4"	70	109	73	21	1	110	273
PL-107300040015	2446598	40 x 1 1/2"	70	113	73	21	1	100	299
PL-107300050010	—	50 x 1"	85	113	81	19	1	80	312
PL-107300050013	—	50 x 1 1/4"	85	124	81	21	1	80	350
PL-107300050015	2446599	50 x 1 1/2"	85	118	81	21	1	80	367
PL-107300050020	2446601	50 x 2"	85	127	81	26	1	65	457
PL-107300063015	2446602	63 x 1 1/2"	103	128	92	21	1	50	515
PL-107300063020	2446603	63 x 2"	103	133	92	26	1	50	586

## Serie.1 Tippunion PE/Messing innvendig gjenger G\* Parallell PL-1073

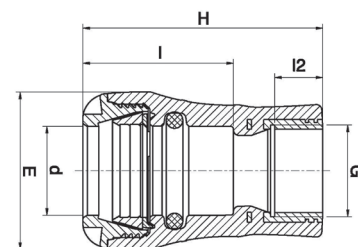

Varenummer	NRF	d x G	E	H	I	l2	AP	AK	V
PL-1073G0025007	—	25 x 3/4"	47	78	48	12	1	240	104
PL-1073G0025010	—	25 x 1"	47	89	48	13,5	1	200	136
PL-1073G0032007	—	32 x 3/4"	58	86	56	12	1	200	158
PL-1073G0032010	—	32 x 1"	58	88	56	13,5	1	160	104

Serie.1 T-rør

PL-1004

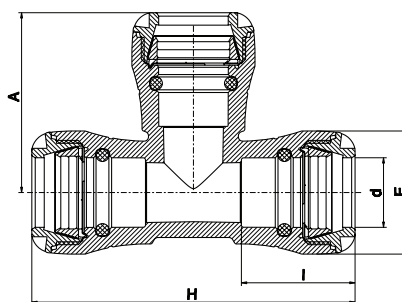

Varenummer	NRF	d	E	H	A	I	AP	AK	V
PL-100400020	2446547	20	41	123	71	45	1	140	103
PL-100400025	2446548	25	47	134	78	48	1	130	137
PL-100400032	2446549	32	58	152	84	54	1	75	221
PL-100400040	2446551	40	70	192	108	70	1	45	429
PL-100400050	2446552	50	85	214	124	78	1	30	667
PL-100400063	2446553	63	103	262	147	90	1	14	1157

Serie.1 T-rør reduksjon

PL-1034

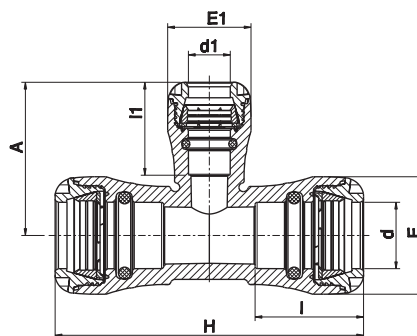

Varenummer	NRF	d x d1 x d	H	A	E	E1	I	l1	AP	AK	V
PL-103400025020	2446677	25 x 20 x 25	134	73	47	41	48	46	1	120	127
PL-103400032020	—	32 x 20 x 32	152	75	58	41	54	46	1	80	185
PL-103400032025	—	32 x 25 x 32	152	81	58	47	54	49	1	80	195
PL-103400040025	—	40 x 25 x 40	192	86	70	47	70	49	1	—	—
PL-103400040032	—	40 x 32 x 40	192	93	70	58	70	54	1	55	358
PL-103400050025	*	50 x 25 x 50	214	90	85	47	78	49	1	—	—
PL-103400050032	*	50 x 32 x 50	214	98	85	58	78	54	1	—	—
PL-103400063025	*	63 x 25 x 63	262	96	103	47	90	49	1	—	—
PL-103400063032	*	63 x 32 x 63	262	100	103	58	90	54	1	—	—

\*Estimert tilgjengelig i løpet av Q3 2015

## Serie.1 T-rør innvendig gjenger

PL-1014

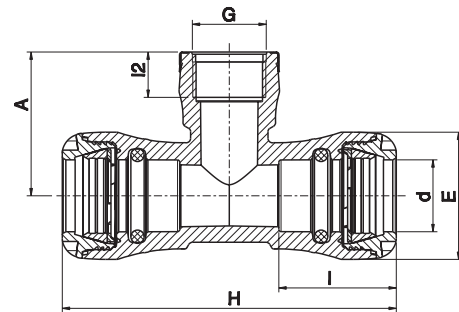

Varenummer	NRF	d x G	E	H	A	I	l <sub>2</sub>	AP	AK	V
PL-101400020005	2446657	20 x 1/2"	41	123	43	45	17	1	200	84
PL-101400020007	2446658	20 x 3/4"	41	123	46	45	18	1	180	88
PL-101400020010	2446659	20 x 1"	41	123	52	45	21	1	180	99
PL-101400025005	2446661	25 x 1/2"	47	134	46	48	17	1	140	105
PL-101400025007	2446662	25 x 3/4"	47	134	48	48	18	1	140	107
PL-101400025010	2446663	25 x 1"	47	134	54	48	21	1	140	114
PL-101400032007	—	32 x 3/4"	58	152	52	54	18	1	80	172
PL-101400032013	—	32 x 1"	58	152	55	54	21	1	80	183
PL-101400032013	—	32 x 1 1/4"	58	152	63	54	24	1	60	215

## Serie.1 Ablue 90°

PL-1005

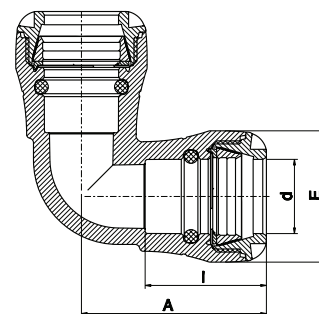

Varenummer	NRF	d	E	A	I	AP	AK	V
PL-100500020	2446554	20	41	67	45	1	200	75
PL-100500025	2446555	25	47	73	48	1	190	96
PL-100500032	2446556	32	58	81	54	1	130	157
PL-100500040	2446557	40	70	106	70	1	65	291
PL-100500050	2446558	50	85	119	78	1	40	462
PL-100500063	2446559	63	103	141	90	1	25	799

Serie.1 Ablue 90° reduksjon

PL-1051

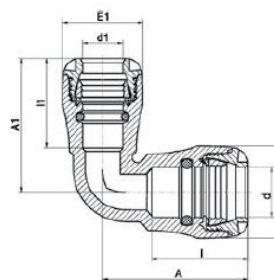

Varenummer	NRF	dxd1	E	A	I	AP	AK	V
PL-105100025020	—	25 x 20	47	74	48	1	160	90

Serie.1 Ablue 45°

PL-1005

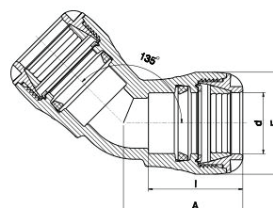

Varenummer	NRF	d	E	A	I	AP	AK	V
PL-100600032	—	32	58	67	54	5	120	147
PL-100600040	—	40	70	88	71	1	80	263
PL-100600050	—	50	85	100	79	1	40	428
PL-100600063	—	63	103	118	90	1	25	719

## Serie.1 Veggbrakett

PL-1075

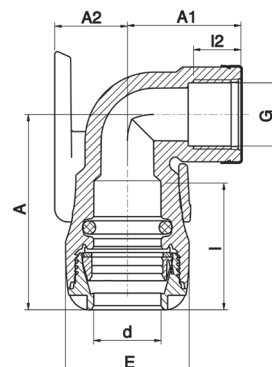
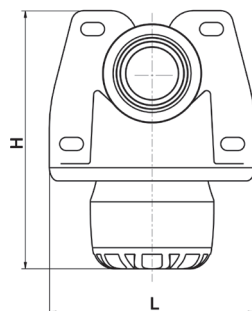

Varenummer	NRF	d x G	E	l	l2	A	A1	A2	L	H	AP	AK	V
PL-107500020005	2446682	20 x 1/2"	41	45	17	67	39	28	73	95	1	160	92
PL-107500020007	2446683	20 x 3/4"	41	45	18	67	43	28	73	95	1	160	96
PL-107500025005	2446684	25 x 1/2"	47	48	17	74	40	28	78	98	1	140	110
PL-107500025007	2446685	25 x 3/4"	47	48	ww18	74	43	28	78	98	1	140	116

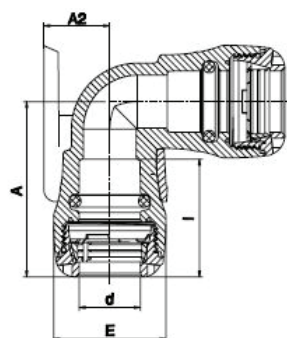
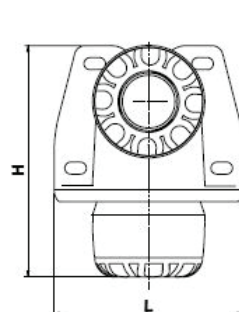

Varenummer	NRF	d x d	E	l	A	A2	L	H	AP	AK	V
PL-107500025020	—	25 x 25	47	48	74	28	78	98	5	—	—

## 90° Albue metrisk til tommer

1005M

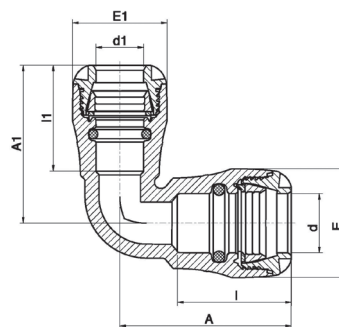

Varenummer	NRF	dxd1	A	E	l	A1	E1	l1	AP	AK	V
PL-1005M6025005	—	25x1/2"	74	47	48	68	41	46	1	—	—
PL-1005M6025007	—	25x3/4"	73	47	48	73	47	48	1	160	101

Serie.1 Tippunion albue 90° utvendig gjenger

PL-1085

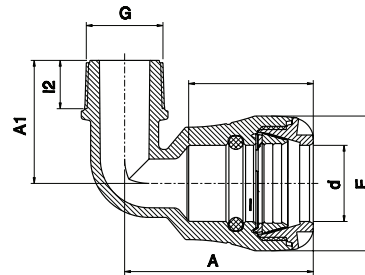

Varenummer	NRF	d x G	E	A	I	A1	l2	AP	AK	V
PL-108500020005	2446604	20 x 1/2"	41	66	45	41	16	1	300	47
PL-108500020007	2446605	20 x 3/4"	41	66	45	42	17	1	300	52
PL-108500025005	2446606	25 x 1/2"	47	74	48	44	16	1	290	57
PL-108500025007	2446607	25 x 3/4"	47	74	47	45	17	1	250	64
PL-108500025010	2446608	25 x 1"	47	74	47	47	19	1	220	65
PL-108500032007	2446609	32 x 3/4"	58	81	53	51	17	1	190	90
PL-108500032010	2446611	32 x 1"	58	81	53	53	19	1	180	92
PL-108500032013	2446612	32 x 1 1/4"	58	81	53	54	21	1	150	114
PL-108500040010	2446613	40 x 1"	70	107	71	57	19	1	90	179
PL-108500040013	2446614	40 x 1 1/4"	70	107	71	58	21	1	90	189
PL-108500040015	2446615	40 x 1 1/2"	70	107	71	60	21	1	90	200
PL-108500050013	—	50 x 1 1/4"	85	122	79	68	22	1	65	275
PL-108500050015	2446616	50 x 1 1/2"	85	122	79	68	21	1	65	290
PL-108500050020	—	50 x 2"	85	122	79	73	21	1	—	315
PL-108500063013	—	63 x 1 1/4"	103	143	90	76	22	1	40	445
PL-108500063020	—	63 x 1 1/2"	103	143	90	78	21	1	40	458
PL-108500063020	2446617	63 x 2"	103	143	90	81	25	1	40	492

Serie.1 Tippunion albue 90° innvendig gjenger

PL-1015

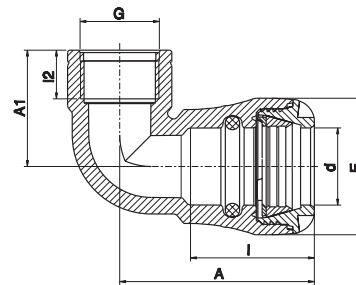

Varenummer	NRF	d x G	E	I	A	A1	l2	AP	AK	V
PL-101500020005	2446667	20 x 1/2"	41	45	67	39	17	1	240	51
PL-101500020007	2446668	20 x 3/4"	41	45	67	43	18	1	240	55
PL-101500020010	2446669	20 x 1"	41	45	67	49	21	1	240	64
PL-101500025005	2446671	25 x 1/2"	47	48	74	40	17	1	220	64
PL-101500025007	2446672	25 x 3/4"	47	48	74	43	18	1	200	70
PL-101500025010	2446673	25 x 1"	47	48	74	50	21	1	180	82
PL-101500032007	2446674	32 x 3/4"	58	54	83	45	18	1	180	95
PL-101500032010	2446675	32 x 1"	58	54	83	49	21	1	160	111
PL-101500032013	2446676	32 x 1 1/4"	58	54	83	60	24	1	150	145
PL-101500040010	—	40 x 1"	70	72	107	51	21	1	110	179
PL-101500040013	—	40 x 1 1/4"	70	72	107	61	24	1	100	226
PL-101500040015	—	40 x 1 1/2"	70	72	107	65	24	1	90	244
PL-101500050015	—	50 x 1 1/2"	85	79	119	63	24	1	60	330
PL-101500050020	—	50 x 2"	85	79	119	75	29	1	55	349
PL-101500063020	—	63 x 2"	103	90	141	70	29	1	35	531

## Serie.1 Tippunion Messing albue 90° utv. gjenger

PL-1077

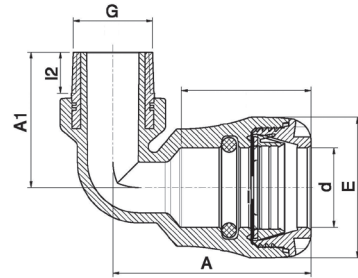

Varenummer	NRF	d x G	E	l	A	A1	l2	AP	AK	V
PL-107700032007	—	32 x 3/4"	58	53	81	51	15	1	120	239
PL-107700032010	—	32 x 1"	58	53	81	55	17	1	120	258
PL-107700032013	—	32 x 1 1/4"	58	53	81	66	19	1	120	284
PL-107700032015	—	32 x 1 1/2"	58	53	73	70	19	1	120	305
PL-107700040010	—	40 x 1"	70	59	92	55	17	1	90	239
PL-107700040013	—	40 x 1 1/4"	70	59	92	66	19	1	90	295
PL-107700040015	2446689	40 x 1 1/2"	70	59	92	72	19	1	85	341
PL-107700050010	—	50 x 1"	85	79	116	62	19	1	70	337
PL-107700050013	—	50 x 1 1/4"	85	79	116	68	21	1	70	384
PL-107700050015	—	50 x 1 1/2"	85	79	116	73	21	1	50	431
PL-107700050020	2446691	50 x 2"	85	79	122	73	21	1	50	549
PL-107700063013	—	63 x 1 1/4"	103	90	134	74	21	1	30	559
PL-107700063015	—	63 x 1 1/2"	103	90	134	74	21	1	40	588
PL-107700063020	2446692	63 x 2"	103	90	143	82	26	1	40	726

## Serie.1 Tippunion Messing albue 90° innv. gjenger

PL-1076

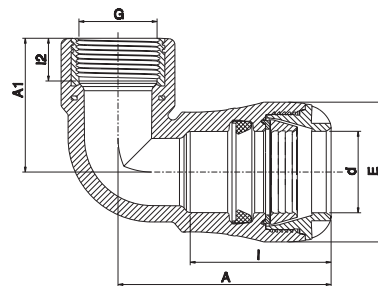

Varenummer	NRF	d x G	E	l	A	A1	l2	AP	AK	V
PL-107600032010	—	32 x 1"	58	53	73	60	19	1	140	187
PL-107600040007	—	40 x 3/4"	70	72	107	51	16	1	—	223
PL-107600040010	—	40 x 1"	70	72	107	60	19	1	90	255
PL-107600040013	—	40 x 1 1/4"	70	72	107	67	21	1	90	313
PL-107600040015	2446689	40 x 1 1/2"	70	72	107	70	21	1	75	355
PL-107600050010	—	50 x 1"	85	79	122	60	19	1	70	354
PL-107600050013	—	50 x 1 1/4"	85	79	122	67	21	1	60	403
PL-107600050015	—	50 x 1 1/2"	85	79	122	73	21	1	40	575
PL-107600050020	2446691	50 x 2"	85	79	122	84	26	1	50	558
PL-107600063013	—	63 x 1 1/4"	103	90	143	68	21	1	40	575
PL-107600063015	—	63 x 1 1/2"	103	90	143	77	21	1	40	621
PL-107600063020	—	63 x 2"	103	90	143	82	26	1	40	747



### Serie.1 Stoppekran

PL-03410

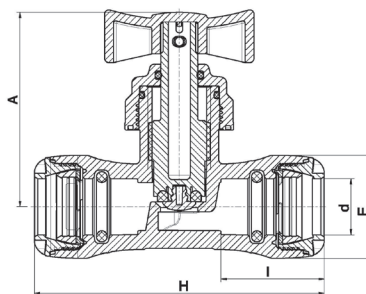

Varenummer	NRF	d	H	A	E	I	AP	AK	V
PL-034100020	2446654	20	123	89	41	45	1	100	145
PL-034100025	2446655	25	134	89	47	48	1	100	167
PL-034100032	2446656	32	152	89	58	54	1	80	225

### Serie.1 Stoppekran reduksjon

PL-03410

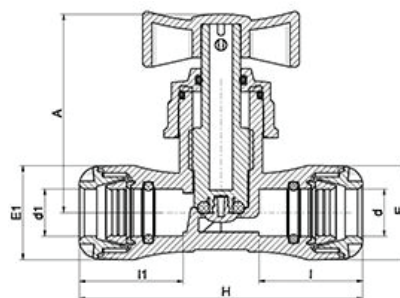

Varenummer	NRF	d x d1	H	A	E1	E	I	I1	AP	AK	V
PL-034100025020	—	25 x 20	129	89	42	47	48	45	1	100	161

### Serie.1 Stoppekran kobber

PL-0341C

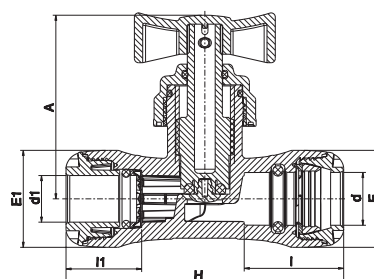

Varenummer	NRF	d x d1	H	A	E	E1	I	I1	AP	AK	V
PL-0341C0020015	2446693	20 x 15	123	89	41	41	45	45	1	100	149
PL-0341C0025015	2446694	25 x 15	129	89	47	42	48	46	1	100	165
PL-0341C0025022	2446695	25 x 22	134	89	47	47	48	48	1	100	171
PL-0341C0032028	2446696	32 x 28	152	89	58	58	54	54	1	80	223

## Serie.1 Free nut union for vannmåler

035891

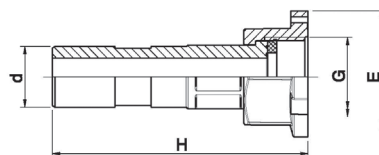

Varenummer	NRF	Gxd	E	H	AP	AK	V
PL-0358916020	—	¾"x 20	44	86	1	150	37
PL-0358916025	—	1"x 25	52	90	1	150	53

## Serie.1 Hakenøkkel

PL-10990

Varenummer	NRF	Størrelse	AP	AK	V
PL-10990002P	2446625	20 - 32	1	300	57
PL-10990004P	2446626	40 - 63	1	100	285



## Serie.1 Grå låsemutter

PL-10004

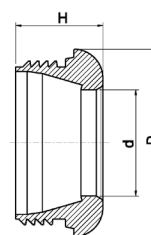

Varenummer	NRF	d	D	H	AP	AK	V
PL-100040020P	2446641	20	40	22	50	700	7
PL-100040025P	2446642	25	45	22	50	500	8
PL-100040032P	2446643	32	57	24	50	300	15
PL-100040040P	2446644	40	68	33	—	400	29
PL-100040050P	2446645	50	83	37	—	125	44
PL-100040063P	2446646	63	100	43	—	100	60

Serie.1 O-Ring / O-Ring for kobber ring adapter\* PL-10002 / PL-10002C\*



Varenummer	NRF	Rørdim.	E	e	AP	AK	V
PL-10002C0020	—	15*	13.6	4	50	32000	1
PL-100020020P	2446627	20	19	4	50	32000	1
PL-10002C0025	—	22*	20.6	4.1	50	16000	1
PL-100020025P	2446628	25	24	5	50	16000	2
PL-10002C0032	—	28*	26.8	3.9	50	10000	1
PL-100020032P	2446629	32	31	6	50	10000	4

Serie.1 Pakning PL-100029

PL-100029



Varenummer	NRF	Rørdim.	E	e	AP	AK	V
PL-100029040P	2446631	40	38	10	50	4000	8
PL-100029050P	2446632	50	48.6	10.5	50	2500	11
PL-100029063P	2446633	63	60.6	11.2	50	2000	15

Serie.1 Split ring PL-10003

PL-10003

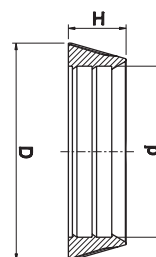

Varenummer	NRF	d	D	H	AP	AK	V
PL-100030020P	2446634	20	27	9	50	6000	2
PL-100030025P	2446635	25	32	9	50	4500	3
PL-100030032P	2446636	32	41	11	50	2000	4
PL-100030040P	2446637	40	52	14	—	1600	14
PL-100030050P	2446638	50	64	17	—	500	14
PL-100030063P	2446639	63	81	21	—	500	27

## Serie.1 Gripe Ring

PL-10008

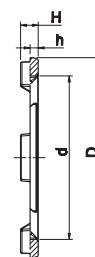

Varenummer	NRF	d	D	H	h	AP	AK	V
PL-100080020P	2446647	20	27	3.7	1.7	50	7000	1
PL-100080025P	2446648	25	33	3.7	1.7	50	5500	1
PL-100080032P	2446649	32	47	3.7	1.7	50	3000	1
PL-100080040P	2446651	40	52	4.0	2.2	50	2500	2
PL-100080050P	2446652	50	64	4.3	2.5	50	1000	3
PL-100080063P	2446653	63	80	4.8	3.0	50	1000	6

## Serie.1 Avstandsring for kobber rør adapter

PL-1099C

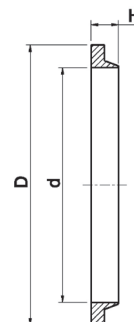

Varenummer	NRF	d	D	H	AP	AK	V
PL-10099C015	—	15	21	2.7	50	—	0.4
PL-10099C022	—	22	28	3	50	—	0.4
PL-10099C028	—	28	34	3	50	—	1

## Serie.1 Gripe ring for kobber rør adapter

PL-10008C

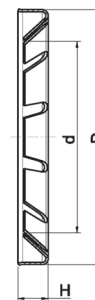

Varenummer	NRF	d	D	H	AP	AK	V
PL-10008C015	—	15	21	3.4	50	6000	1
PL-10008C022	—	22	28	3.9	50	5000	1
PL-10008C028	—	28	34	3.6	50	3000	1

PVC rør adapter sett

PL-1091Q

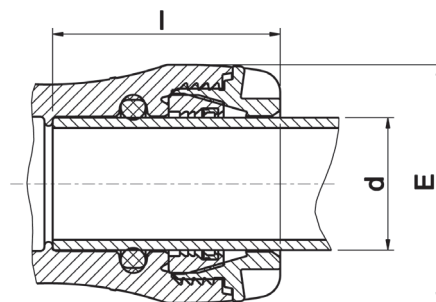
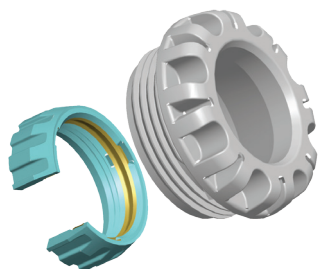

Varenummer	NRF	d	E	l	AP	AK	V
PL-1091Q0025	—	25	47	50	1	300	263
PL-1091Q0032	—	32	58	55	1	300	371
PL-1091Q0040	—	40	70	72	1	300	56

## Installasjons veiledning

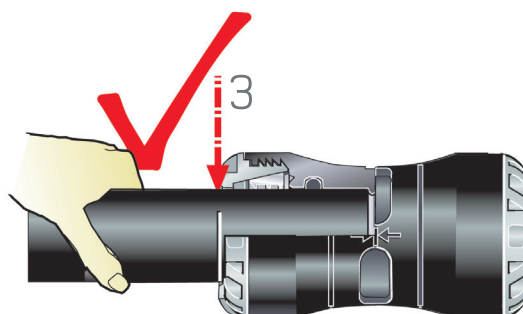
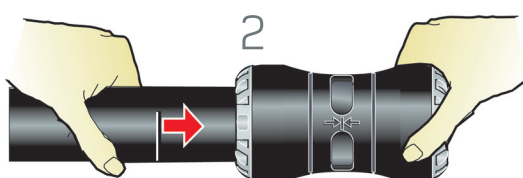
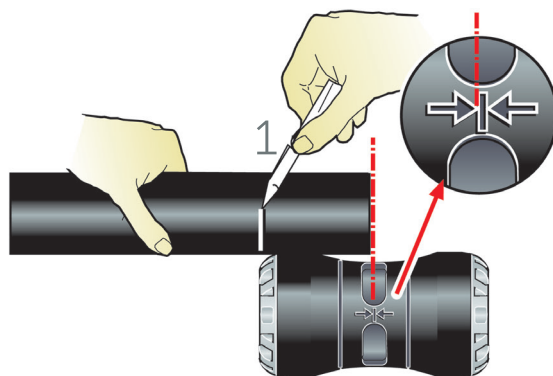

## Demontering

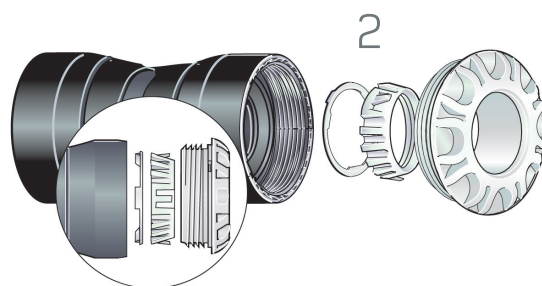
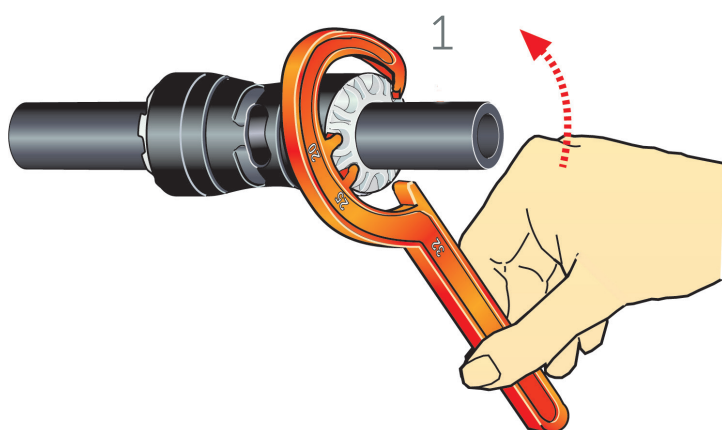



# Produktsertifikat

## Nr. 1601

SINTEF Byggforsk bekrefter at

### **Plasson innstikkskoplinger for PE-rør, dimensjon 20 – 63mm**

er i samsvar med kravene i

NS-EN 712, 713, 715 og 911

Innehaver av sertifikatet:

#### **Eurofusion AS-EFAS**

Kongeveien 129  
1407 Vinterbro

Produsent:

Plasson Industries Ltd  
37805 D.N. Menashe  
Israel

Utstedt : 17.01.2011  
Gyldig frem til: 01.04.2016

Produsenten er sertifisert etter ISO 9001

.....  
Knut Ivar Edvardsen  
Sertifiseringsleder

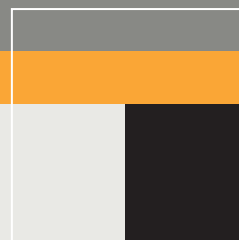

EUROFUSION AS

Kongeveien 129

1407 Vinterbro

Tel: 64 00 70 60

Fax: 64 00 70 69

E-mail: [info@efas.no](mailto:info@efas.no)

[www.efas.no](http://www.efas.no)