

Installation instructions

for floating installation

Dear customer,

We thank you for purchasing our Parky floor.

Before starting the installation, it is essential to read these instructions carefully. If these instructions are not followed, the instructor will be deemed fully responsible.

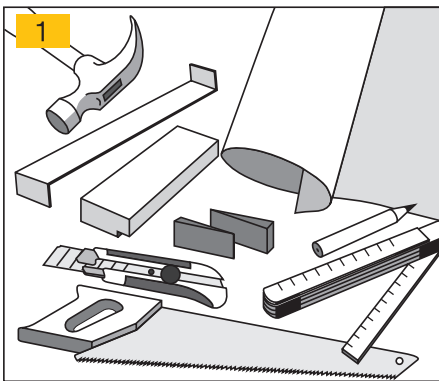

INSTALLATION MATERIALS (Pic. 1)

- Parky Installation Kit (Hitting block - Expansion spacer - Striking bar)
- Quality underlay:
 - Parky WITH an integrated cork layer: Damp-proof foil
 - Parky WITHOUT an integrated cork layer: Basic or Silent underlay
- Parky waterproof tape
- Hammer, pencil, saw, cutter and meter

Do not use glue, screws or nails during the floating installation of Parky. For glued-down installation, see instructions at www.par-ky.com at downloads.

Never hit the boards directly with a hammer. Always use the tapping block to protect the edges of the boards. (Pic. 2)

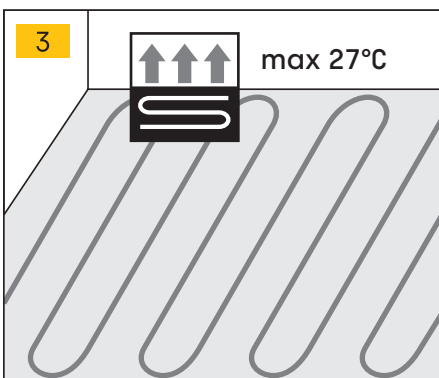
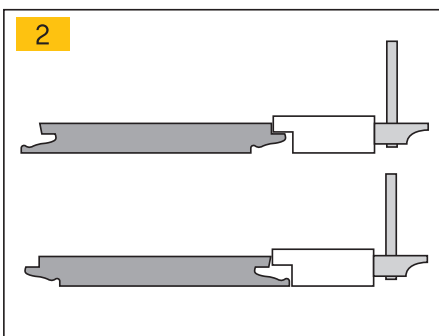

UNDERFLOOR HEATING (Pic. 3)

Parky floors can be installed over underfloor heating. Follow the instructions of the floor heating manufacturer. The maximum allowed contact temperature is 27°C (80°F). You can find our installation instructions on www.par-ky.com.

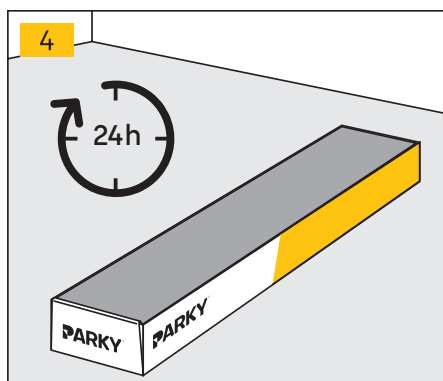

STORAGE: Store Parky floors in a perfectly dry and protected room with an air humidity of 40 to 60% and a temperature of 16 to 21° C (61-70° F). In order to prevent deformation, avoid placing the boxes directly on the ground or in direct sunlight. Warning: Do not open the boxes until the moment of installation.

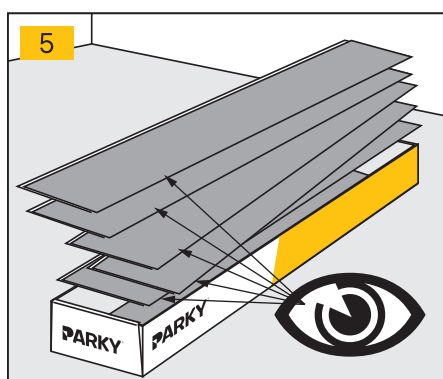

PREPARATIONS: Put the Parky boxes in the relevant room 24 hours before installation. Put the boxes in the middle of the room and certainly not against a wall. **(Pic. 4)** Open the packs just before installation. Check every board carefully. Do not install boards with defects. **(Pic. 5)**

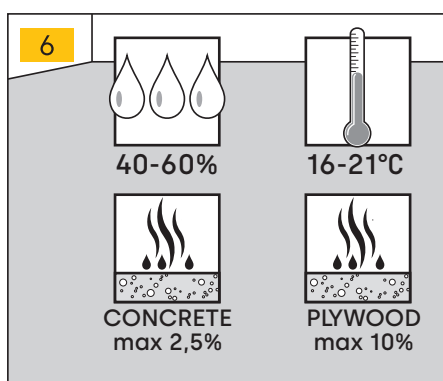

Remark: Veneer flooring is a natural product and therefore unique so no boards are identical. Minor variations in colour and structure are normal. Small natural marks such as knots and mineral streaks are tolerated and have no effect on the quality of the floor. We strongly advise to use the same production batch per room in order to obtain the most uniform result. You can find the production number on the backing of each board and we highly recommend not to mix 2 different batches.

Defects in the under floor have to be repaired. The under floor must be:

- Clean and dust free
- Sound with no loose particles.
- Flat. The maximum difference in height is 3 mm (1/8") over 2 meters (6' 9/16"). Any unevenness of more than 1 mm (3/64") over a length of 20 cm (7 7/8") must be levelled out.
- Dry. The humidity needs to be less then 2.5% for installation in screed without floor heating, 2% in screed with floor heating, 0.6% in anhydritescreed and 10% in multiplex.

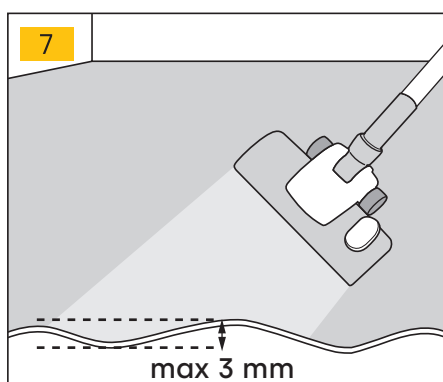

In principle, Parky can be installed on any underfloor that is solid and sound. The ideal fitting circumstances are a temperature between 16°C (61°F) and 21°C (70°F) and an atmospheric humidity between 40% and 60%. **(Pic. 6 & 7)**

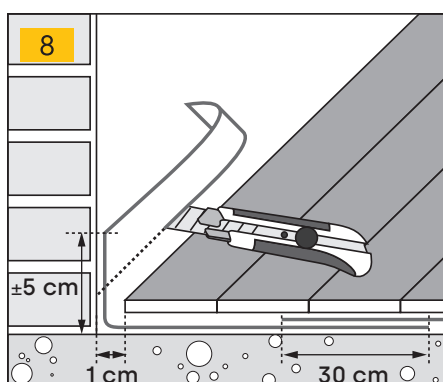

UNDERLAY (Pic. 8)

- For the collections with an integrated cork layer, we recommend to use our 150 micron Parky damp screen under the floor. Allow an overlap of 30 cm (12"), stick the edges of the foil together with Parky moisture-resistant tape and make sure there are no holes in the foil. Put the foil 5 cm (2") up the wall to avoid moisture under the flooring.
- If your floor doesn't have an integrated cork layer, use our Basic or Silent underlay. In humid climates or when there is a humidity risk in the wall, we suggest to fold the underlay 5cm up to the wall or use waterproof tape to seal the underlay against the wall. This to avoid that humidity damages the floor.

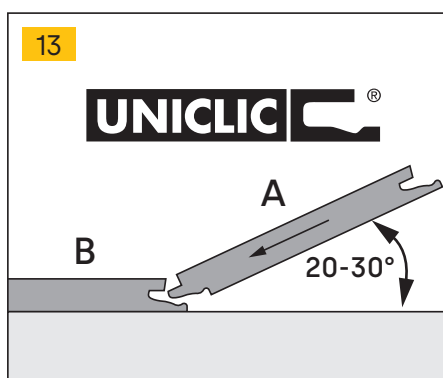
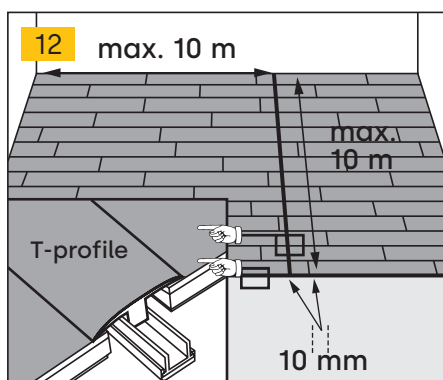
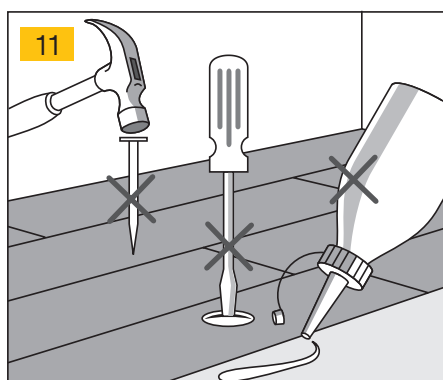
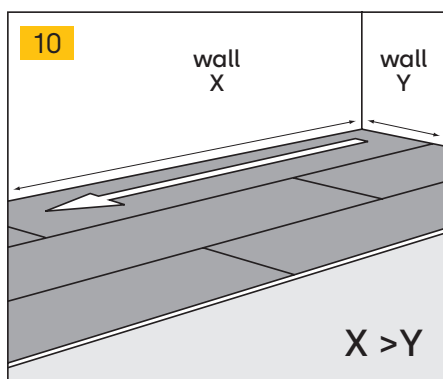
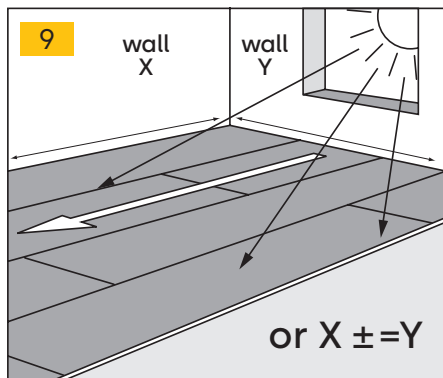

LAYOUT: We recommend to install the floor towards the light or in the direction of the longest wall. **(Pic. 9 & 10)**

Remark: Some wood species are sensitive to colour variations under the influence of UV light. It is a natural phenomenon that colours darken or lighten in the course of time.

INSTALLATION: We recommend mixing planks from different boxes during installation to create a more uniform appearance.

Parky uses the Uniclic® system for the installation of floating floors without glue, nails or screws. **(Pic. 11)** The floorboards are held together using a click tongue-and-groove system. This system allows faster, fault-free laying.

The easiest way to install the floor is putting the tongue (A) in the groove (B). **(Pic. 12)**

Use the Parky striking bar in case you cannot use the hitting block and the hammer. On the short edge, give knocks one after the other. Do not give heavy strokes to avoid damage.

While using the striking bar at the long edge, knock the board repeatedly.

Start knocking softly at the end of the board until it is clicked together and repeat this process every 30 cm (12") until the whole board is clicked together.

Parky is a real wood floor. Sufficient expansion gaps should therefore be left along each wall, around heating pipes, and around obstacles on the surface (for example door frames).

The minimum expansion gap is 10 mm, or 1 mm per running metre. The expansion gaps can be covered with skirtings attached to the wall, but NEVER to the floor. For floors that are longer or wider than 10 m, an additional expansion gap must be provided using a T-profile. **(Pic. 13)**

Heavy/fixed objects (such as kitchen islands, built-in cabinets, heavy stoves...) should be perceived as walls when installing flooring and therefore require the minimum expansion gap.

For an easier installation, assemble the first 3 rows away from the wall, so you can sit on the planks during the assembly. Then slide the first 3 rows against the wall with distance spacers in place.

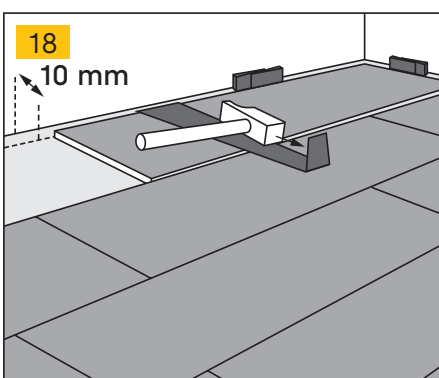
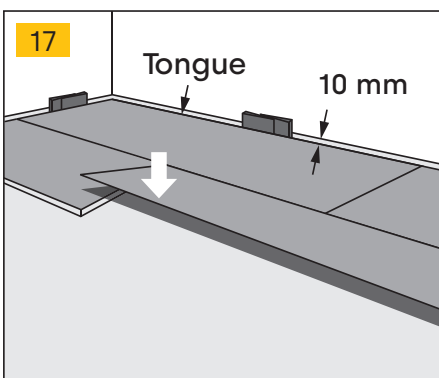
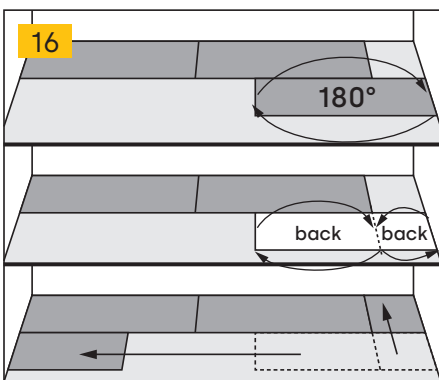
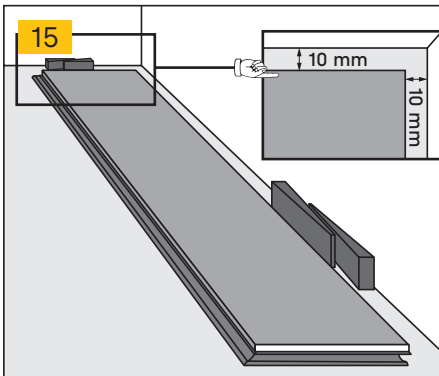
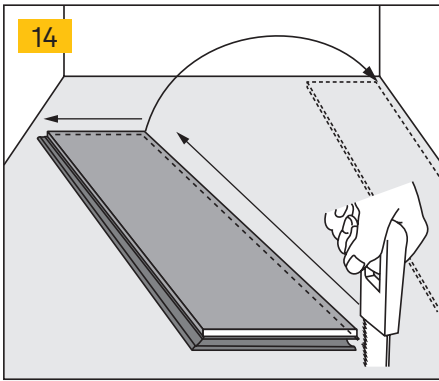

THE FIRST ROW: Cut off the tongue from the first board, both the short edge and the long edge. For the other boards of the first row, only cut off the tongue on the long side. **(Pic. 14 & 15)**

Angle the end joint of the second plank into the end joint of the installed plank. Lower and click the plank into place. Make sure the planks of the first row are straight.

THE SECOND ROW: Use the remainder of the board from the first row to start the second row. The minimum length of the remainder is 20cm (8"). **(Pic. 16)** Continue the second row with a full board. Click first the long edge in row 1. Make sure the distance to the first board of row 2 is about 6 mm (1/4"). Knock this board softly into the first board using the hitting block from the installation kit. **(Pic. 17)**

Continue according to this methodology until the last row. Remark: Never assemble 2 boards by hitting in one stroke!

Avoid aligning the end joints of the planks in two successive rows. We recommend staggering them by at least 30 cm (11 13/16")

THE LAST ROW: Leave again an expansion gap of 10 mm (3/8") between the last board and the wall. Cut the boards of the last row in the length. To click the boards in the second last row, use the metal striking bar from the installation kit. **(Pic. 18)**

DOORFRAMES: Cut the boards and make sure there is an expansion gap of 10 mm (3/8"). Use the striking bar in case it is not possible to click the board. **(Pic. 19 & 20)**

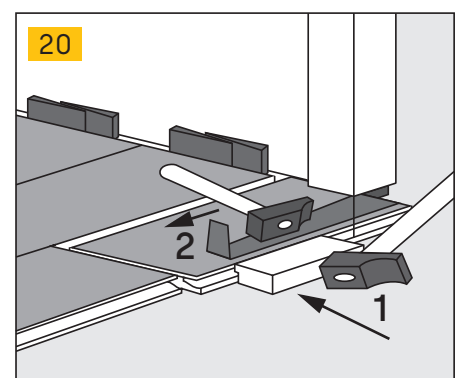

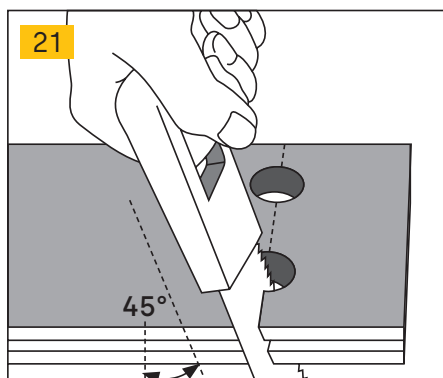

HEATING PIPES: Watch the picture carefully how to cut a Parky board. It is important to follow the instructions to achieve a nice result. Around the pipes you can finish the floor with silicone. It is important that the expansion gap is closed off to avoid moisture in the Parky floor.

(Pic. 21 & 22)

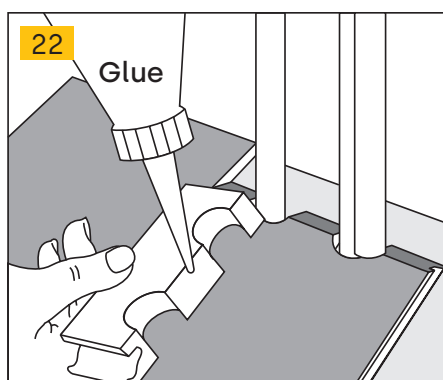

THE FINISH: Due to the fact that the floor is installed without glue, you can immediately walk on the floor after installation. Remove all spacing blocks and install the skirtings. Never fix the skirtings to the floor, but always to the wall. The floor needs to expand and contract under the skirting. Use silicone where you are not able to use a skirting.

In general, the floor has to be sealed to avoid moisture penetration.

MAINTENANCE AND PROTECTION

For an optimal protection of your Parky floor, put:

- Pieces of felt under the chairs.
- Parquet wheels under office chairs and a protection mat under the chair.
- A doormat if the floor is installed at the entrance.

Use the Parky cleaner to maintain your Parky Wood Floor Cleaner. Parky Wood Floor Cleaner removes the dirt without harming the lacquer and it gives your floor a nice look. Contact your dealer for stubborn spots.

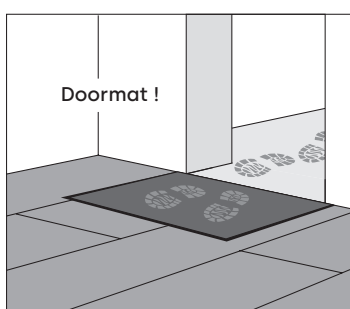
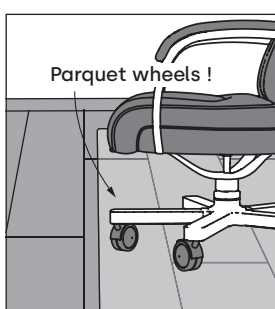
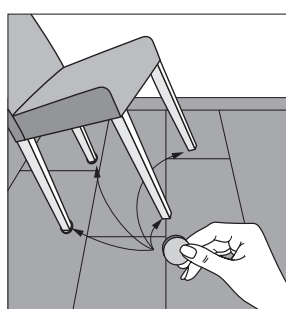

PARKY[®]
It's good to live on wood

If you have any questions, don't hesitate to contact your local dealer or the head office in Belgium.

Decospan nv, Industriezone Grensland
Lageweg 33, 8930 Menen - Belgium
tel +32 56 52 88 49 - info@par-ky.com
www.par-ky.com

DECOSPAN[®]