

GALVANISERTE STÅL LØSFLENSER / GALVANISED CARBON STEEL LOOSE FLANGES

EN 1092-1 type 02 PN10 (DIN 2642)

MATERIALE:

S235JR/ RST37.2

MATERIAL:

S235JR/ RST37.2

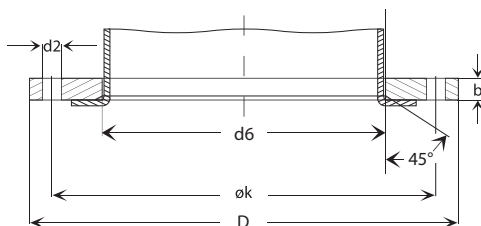

6

HS CODE INT. 7307.91

| DN | Vare nr. Part no. | Rør dim. Pipe dim. d1 | Flens/Flange | | | | Skruer/Bolts | | | Vekt Weight Kg |
|------|----------------------|--------------------------|--------------|--------|--------|-------|--------------|----------|--------|-------------------|
| | | | D(mm) | d6(mm) | øk(mm) | b(mm) | Ant/Qty | Gj/ Thr. | d2(mm) | |
| 15 | 1251425 | 21,3 | 95 | 25,0 | 65 | 14 | 4 | M 12 | 14 | 0,70 |
| 20 | 1251431 | 25,0 | 105 | 28,0 | 75 | 16 | 4 | M 12 | 14 | 0,80 |
| 20 | 1251435 | 26,9 | 105 | 31,0 | 75 | 16 | 4 | M 12 | 14 | 0,80 |
| 25 | 1251441 | 30,0 | 115 | 33,0 | 85 | 16 | 4 | M 12 | 14 | 1,10 |
| 25 | 1251445 | 33,7 | 115 | 38,0 | 85 | 16 | 4 | M 12 | 14 | 1,10 |
| 32 | 1251451 | 38,0 | 140 | 42,0 | 100 | 18 | 4 | M 16 | 18 | 1,60 |
| 32 | 1251455 | 42,4 | 140 | 47,0 | 100 | 18 | 4 | M 16 | 18 | 1,60 |
| 40 | 1251461 | 44,5 | 150 | 50,0 | 110 | 18 | 4 | M 16 | 18 | 1,90 |
| 40 | 1251465 | 48,3 | 150 | 53,0 | 110 | 18 | 4 | M 16 | 18 | 1,90 |
| 50 | 1251471 | 57,0 | 165 | 62,0 | 125 | 20 | 4 | M 16 | 18 | 2,20 |
| 50 | 1251475 | 60,3 | 165 | 65,0 | 125 | 19 | 4 | M 16 | 18 | 2,20 |
| 65 | 1251485 | 76,1 | 185 | 81,0 | 145 | 20 | 8 | M 16 | 18 | 2,60 |
| 80 | 1251491 | 88,9 | 200 | 94,0 | 160 | 20 | 8 | M 16 | 18 | 3,30 |
| 100 | 1251493 | 108,0 | 220 | 113,0 | 180 | 22 | 8 | M 16 | 18 | 3,70 |
| 100 | 1251495 | 114,3 | 220 | 120,0 | 180 | 22 | 8 | M 16 | 18 | 3,70 |
| 125 | 1251501 | 133,0 | 250 | 138,0 | 210 | 22 | 8 | M 16 | 18 | 4,50 |
| 125 | 1251506 | 139,7 | 250 | 145,0 | 210 | 22 | 8 | M 16 | 18 | 4,50 |
| 150 | 1251511 | 159,0 | 285 | 164,0 | 240 | 24 | 8 | M 20 | 22 | 5,60 |
| 150 | 1251515 | 168,3 | 285 | 174,0 | 240 | 24 | 8 | M 20 | 22 | 5,60 |
| 200 | 1251531 | 219,1 | 340 | 226,0 | 295 | 24 | 8 | M 20 | 22 | 8,90 |
| 250 | 1251533 | 267,0 | 395 | 273,0 | 350 | 26 | 12 | M 20 | 22 | 12,20 |
| 250 | 1251535 | 273,0 | 395 | 281,0 | 350 | 26 | 12 | M 20 | 22 | 12,20 |
| 300 | 1251543 | 306,0 | 445 | 318,0 | 400 | 26 | 12 | M 20 | 22 | 14,00 |
| 300* | 1251544 | 323,9 | 445 | 329,0 | 400 | 26 | 12 | M 20 | 22 | 14,00 |
| 300 | 1251545 | 323,9 | 445 | 333,0 | 400 | 26 | 12 | M 20 | 22 | 14,00 |
| 350 | 1251551 | 355,6 | 505 | 365,0 | 460 | 30 | 16 | M 20 | 22 | 19,40 |
| 400 | 1251555 | 406,4 | 565 | 416,0 | 515 | 32 | 16 | M 24 | 26 | 26,40 |
| 450 | 1251556 | 457,0 | 615 | 467,0 | 565 | 36 | 20 | M 24 | 26 | 32,20 |
| 500 | 1251561 | 508,0 | 670 | 519,0 | 620 | 38 | 20 | M 24 | 26 | 38,50 |
| 600 | 1251565 | 609,6 | 780 | 622,0 | 725 | 42 | 20 | M 27 | 30 | 52,20 |

* DIN 2642

Kan leveres med EN 10204- 3.1 sertifikat / Can be delivered with EN 10204- 3.1 certificate.