



SMOKEY JOE® PREMIUM CHARCOAL GRILL

Read owner's guide before using the barbecue.

Lisez le guide d'utilisation avant d'utiliser le barbecue.

Lesen Sie das Benutzerhandbuch, bevor Sie den Grill verwenden.

14½ inch
(37 cm)



EXPLODED VIEW, VUE ÉCLATÉE, EXPLOSIONSDARSTELLUNG

Smokey Joe Premium_EURO 080812

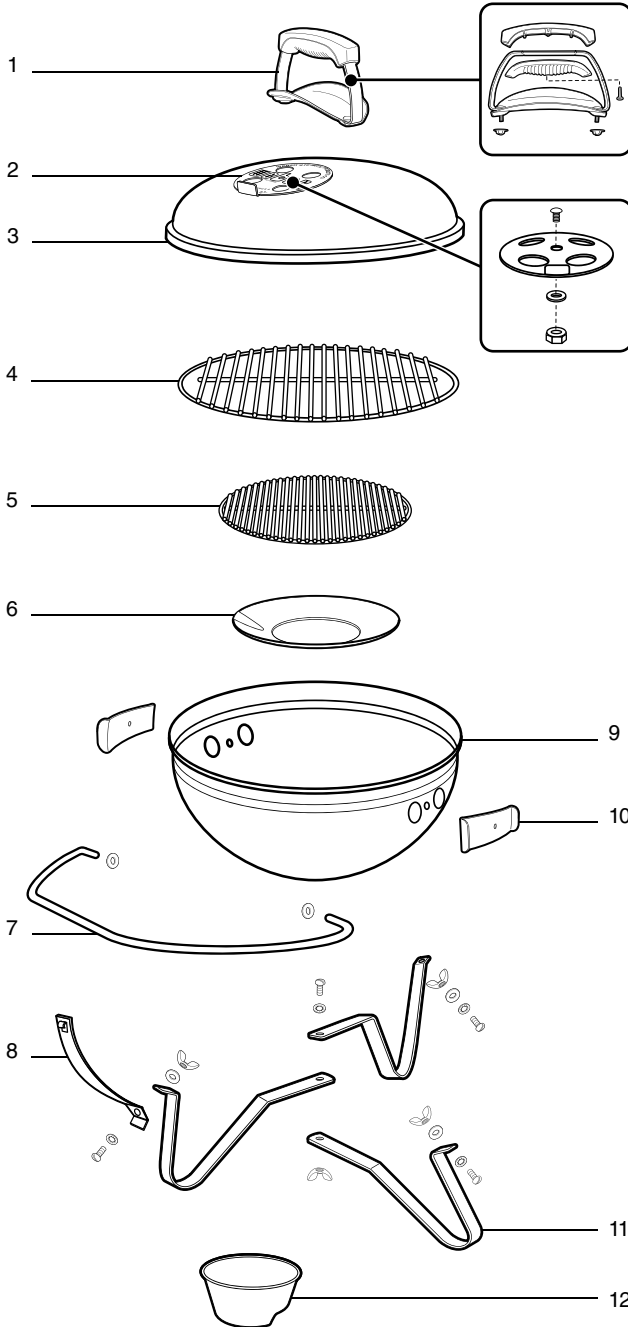

- 1. Lid Handle Assembly**
Poignée du couvercle
Deckelgriff
- 2. Lid Damper Assembly**
Clapet ventilation
couvercle
Deckellüfter
- 3. Lid**
Couvercle
Deckel
- 4. Cooking Grate**
Grille de cuisson
Grillrost
- 5. Charcoal Grate**
Grille foyère
Holzkohlerost
- 6. Catch Pan**
Bac de récupération
Auffangschale
- 7. Lid Lock**
Verrouillage couvercle
Deckelverriegelung
- 8. Lid Lock Support**
Support de verrou de
couvercle
Strebe für
Deckelverriegelung
- 9. Bowl**
Cuve
Kessel
- 10. Bowl Damper**
Clapet ventilation
couvercle
Lüfter am Kessel
- 11. Leg**
Pied
Beine
- 12. Charcoal Cup**
Doseur à Charbon de Bois
Brikett-Portionierer

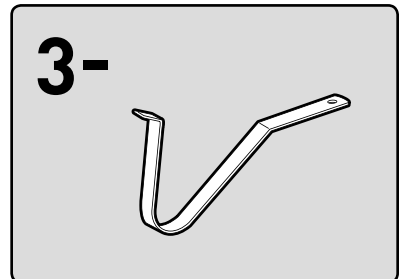
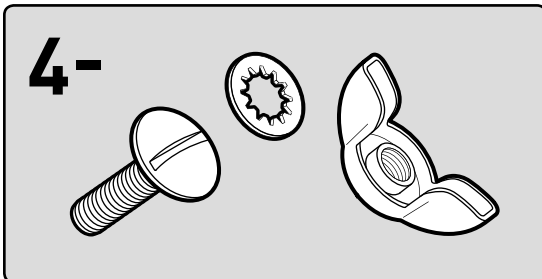
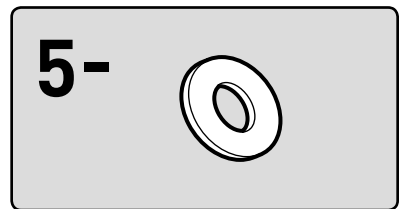
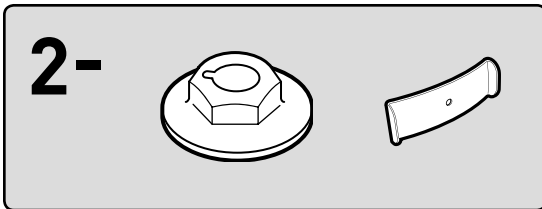
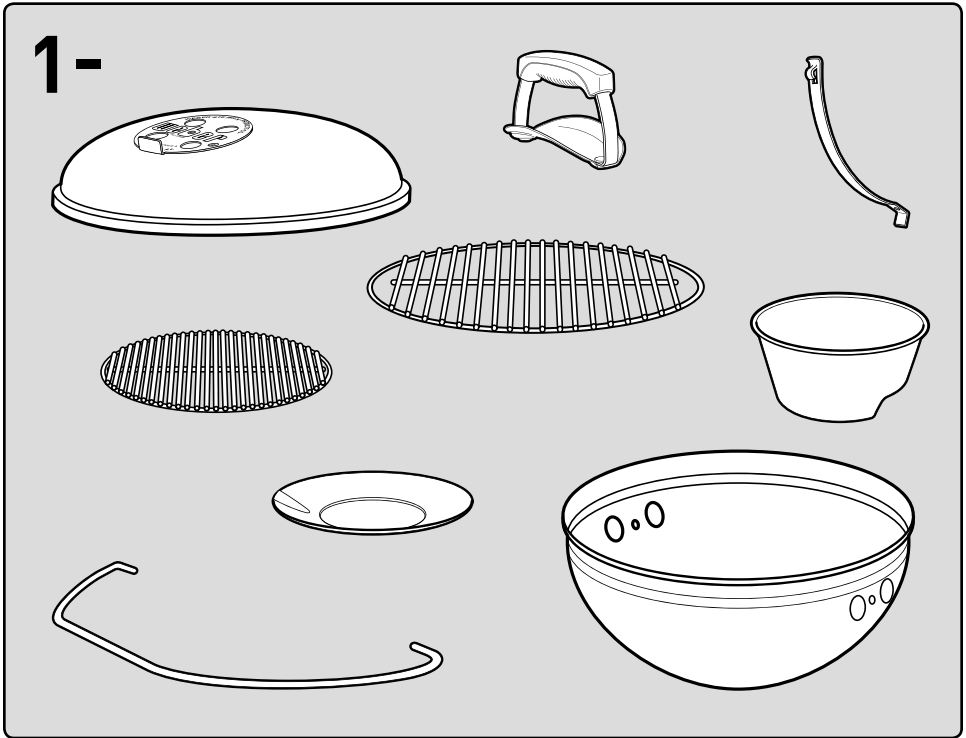
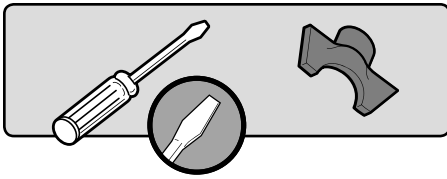

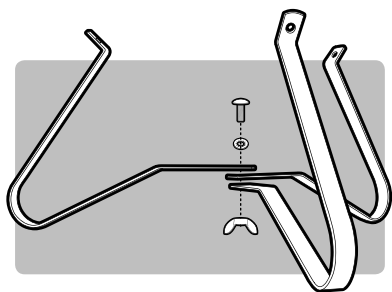
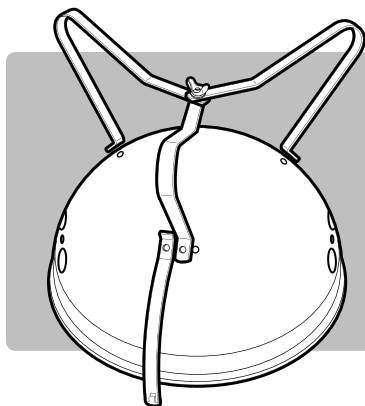
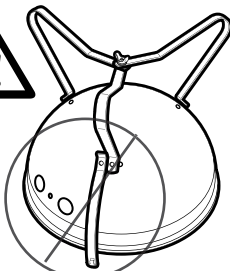
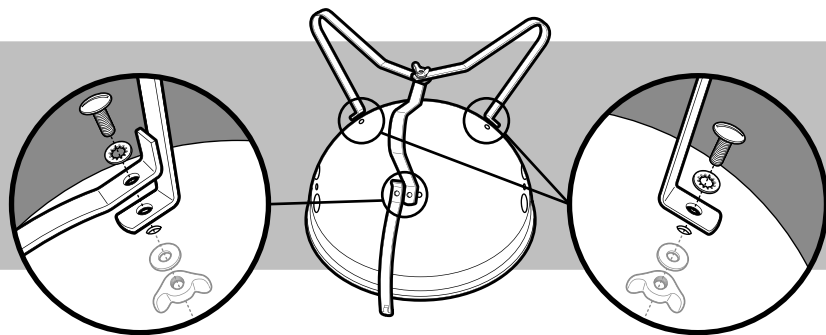
1**1-****2****1-****3****3-**

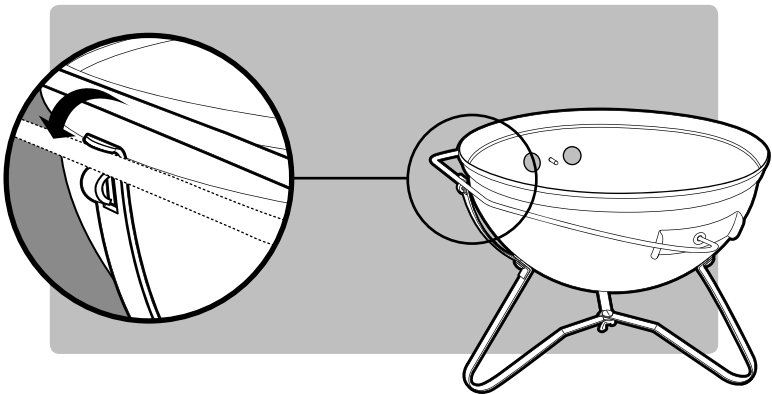
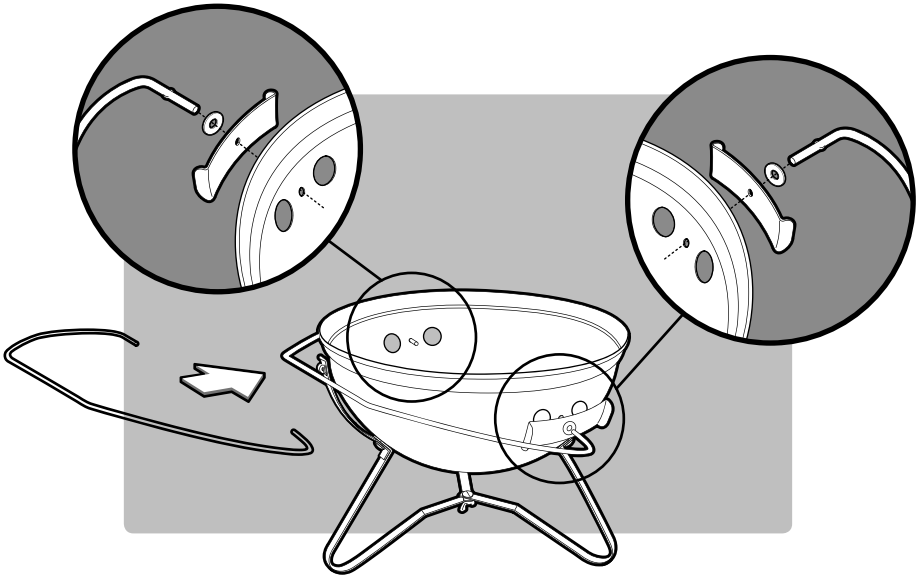

5

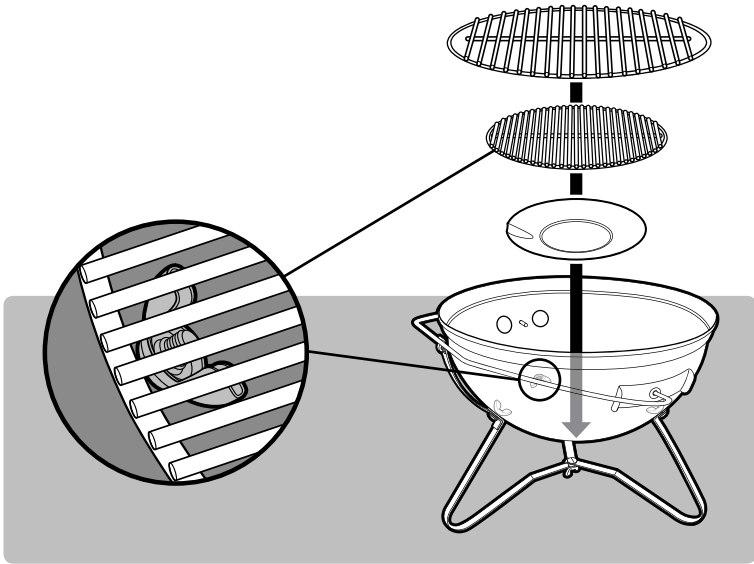

6

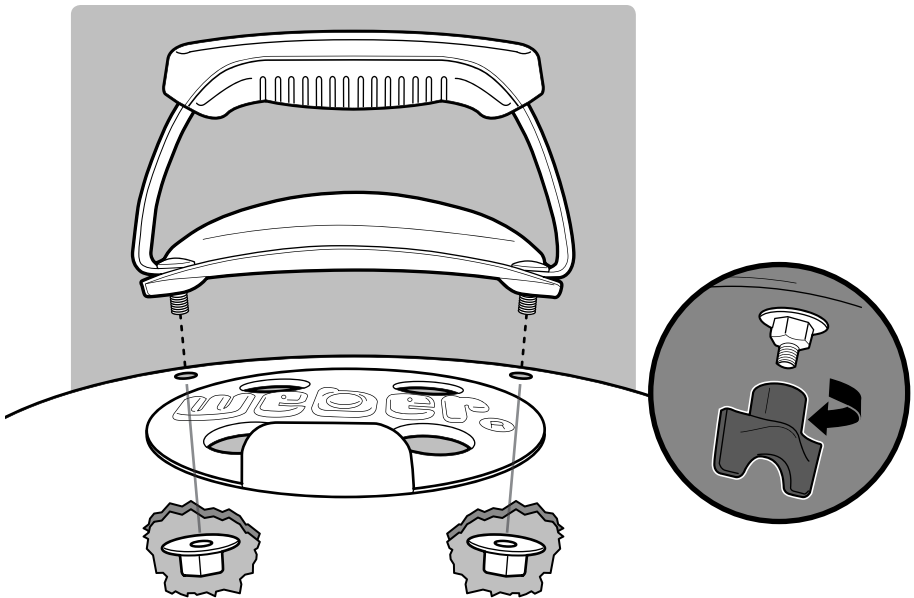

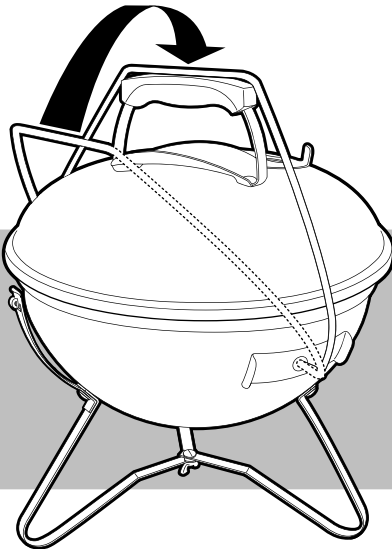
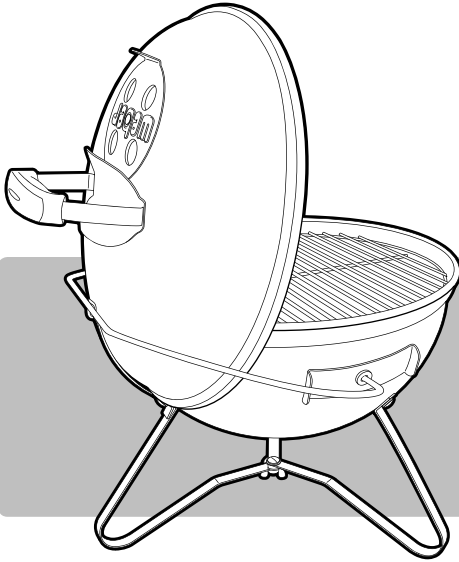



WEBER-STEPHEN PRODUCTS LLC
www.weber.com[®]

© 2013 Designed and engineered by Weber-Stephen Products LLC,
200 East Daniels Road, Palatine, Illinois 60067 U.S.A.
Printed in U.S.A.