

T-head bolt FHS Clix

Hammer-head bolt for quick and easy fixing in FLS channels

2b



Light pipe fixing



Pipe fixing at mounting channel

Applications

- FHS Clix is suitable for connecting pipe clamps with the channel.

Certificates



Fire resistance classification
R120



MLAR R30

Advantages/Benefits

- The special spring leg at the FHS Clix guarantees the necessary contact pressure of the connector to the channel to help for a secure adjustment during installation.
- The teeth on the sliding nut enable an exact and secure positioning in the FLS channel and ease the installation of connector elements.
- The clix-connector element with 90°-turn for connecting enables an easy post-installation in set channels to save time and money.
- The especially developed stop element on the FHS Clix connector guarantees the accurate 90°-turn of the connectors in the channel to ensure a safe and precise installation.

Properties

- Material channel nut: steel S420MC (material no.: 1.0980) acc. DIN EN 10149-2
- Material cover plate: steel S235JR+CR (material no.: 1.0037) acc. DIN 1652
- Material threaded rod: steel acc. DIN 976-2, min. 4.6 (DIN EN ISO 898-1)
- Material hexagonal nut: steel acc. DIN 934-4 min. 4.8 (DIN EN ISO 898-2 table 4 stability)
- Material plastic cage: polypropylene PP, item number 11400, Color black
- Zinc plating: electro zinc-plated, min. 5 µm acc. DIN EN ISO 4042

Installation FHS Clix

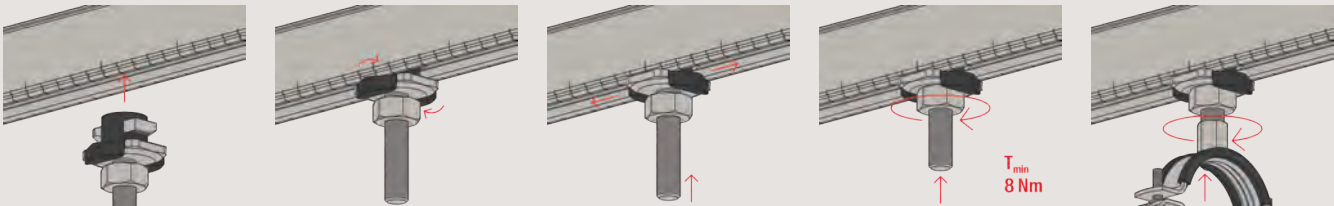

Technical data

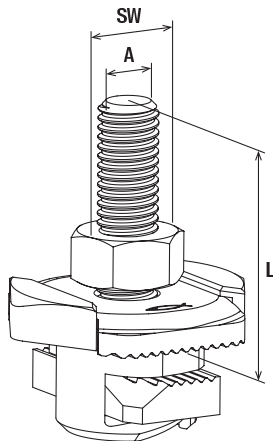

FHS Clix

Item	Item No.	Thread A	Length [mm]	Width across nut SW [mm]	Sales unit [pcs]
FHS Clix 8 x 30	538653	M 8	30	13	100
FHS Clix 8 x 40	538654	M 8	40	13	100
FHS Clix 8 x 60	538655	M 8	60	13	100
FHS Clix 8 x 80	538656	M 8	80	13	50
FHS Clix 8 x 100	538657	M 8	100	13	50
FHS Clix 8 x 140	545834	M 8	140	13	50
FHS Clix 8 x 190	545835	M 8	190	13	50
FHS Clix 10 x 30	538658	M 10	30	17	100
FHS Clix 10 x 40	538659	M 10	40	17	100
FHS Clix 10 x 60	538660	M 10	60	17	50
FHS Clix 10 x 80	545836	M 10	80	17	50
FHS Clix 10 x 100	538661	M 10	100	17	50

Loads

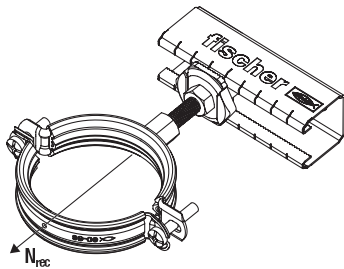

FHS Clix

Item	Item No.	Max. recommended tension load for FLS 17/1.0 and FLS 30/1.0	Max. recommended tension load for FLS 37/1.2	Tightening torque
		N_{rec} [kN]	N_{rec} [kN]	T_{inst} [Nm]
FHS Clix 8 x 30	538653	1.5	2.0	8
FHS Clix 8 x 40	538654	1.5	2.0	8
FHS Clix 8 x 60	538655	1.5	2.0	8
FHS Clix 8 x 80	538656	1.5	2.0	8
FHS Clix 8 x 100	538657	1.5	2.0	8
FHS Clix 10 x 30	538658	1.5	2.0	8
FHS Clix 10 x 40	538659	1.5	2.0	8
FHS Clix 10 x 60	538660	1.5	2.0	8
FHS Clix 10 x 100	538661	1.5	2.0	8