

FIRE RESISTANT INTERNAL DOOR EI30

Description:

Outward opening hinged timber leaf hung in timber frame.

The door is intended to use for closing entrances between the fire compartments of heated working and living premises. The difference of temperature of the rooms so separated cannot exceed 5 °C.

Performance characteristics:

Fire resistance: EI₂30

Self-closing: C0

Technical data:

Dimensions: M7, 8, 9, 10 x 20 or 21. Special door max width M12 and max high M22

Door leaf: Door leaf thickness 40 mm. Standard door is painted, possible to order decorative laminate or veneer.

Door leaf edges: Melamine or 2,0 mm ABS edgeband 2 or 4 sides.

Decoration: In standard the decoration is flush. Glued panels and/or decorative moldings on door leaf can be possible.

Frame: Softwood frame 42 x 92 mm. Frame depth min 68 mm.

Threshold: Hardwood threshold, drop down seal "FT", stainless steel or without a threshold with a non-combustible floor.

Finishing: Door leaf and frame painted white (NCS S 0502-Y), special colours are available

Fittings: Standard lock type Assa 565 or Abloy 2014

Hinges: Abloy 3248-110TMKSS, Abloy 3248-01 FOP or concealed hinges Otlav IN300120

Accessories: - RST kick plate
- door closer
- door viewer

Installation: Insulation material rockwool or fire rated PU foam.

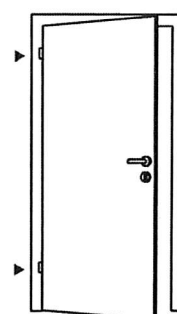
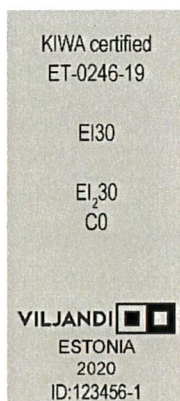
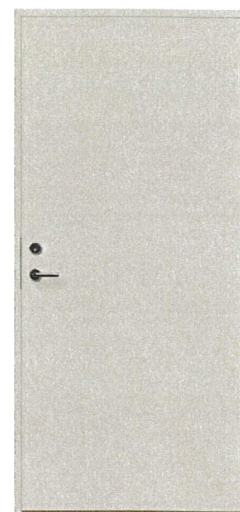
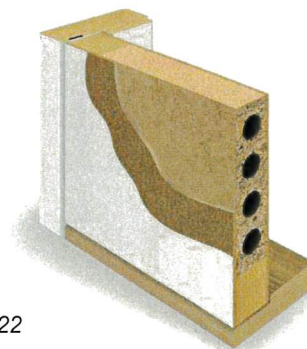

Left handed door

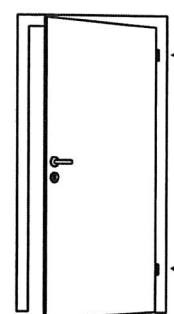

Right handed door

Dimensions	A	A1	B	B1 3248-110	B1 3248-01 FOP	B1 IN300120
M 7	690	625	606	563	604	572
M 8	790	725	706	663	704	672
M 9	890	825	806	763	804	772
M 10	990	925	906	863	904	872

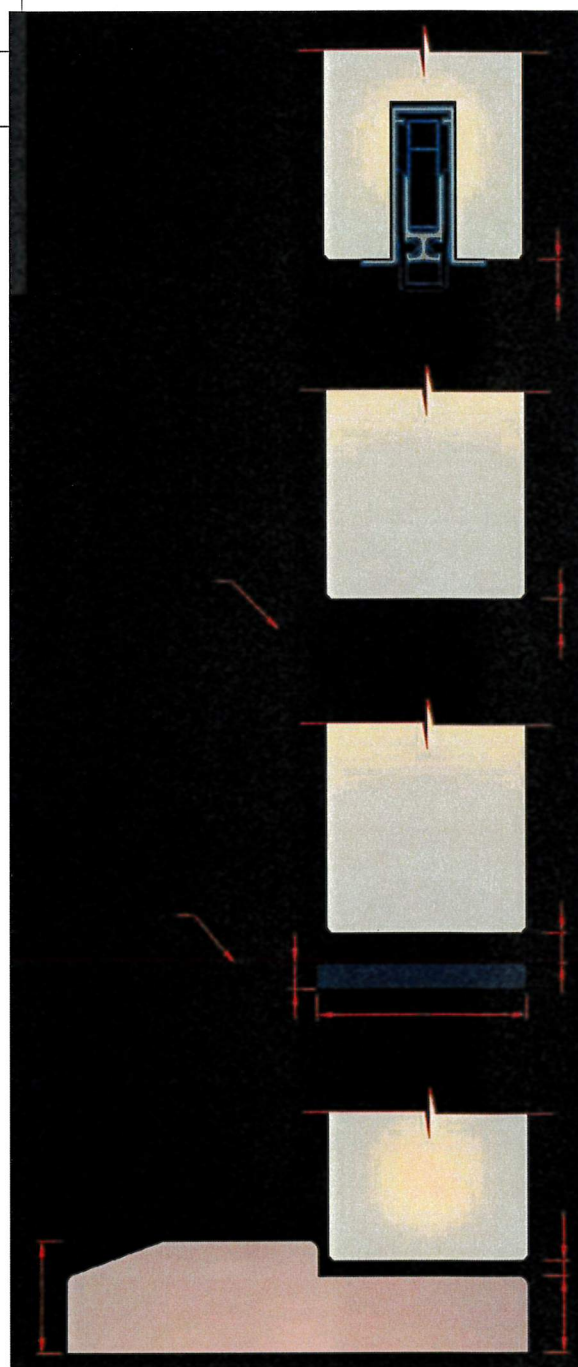
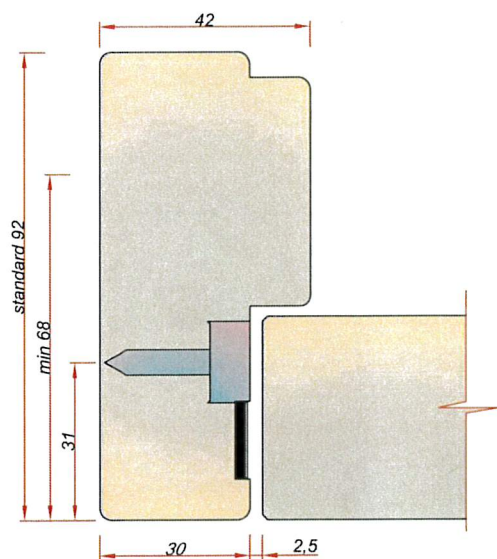
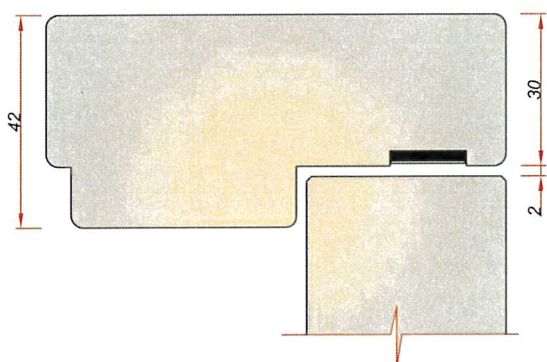
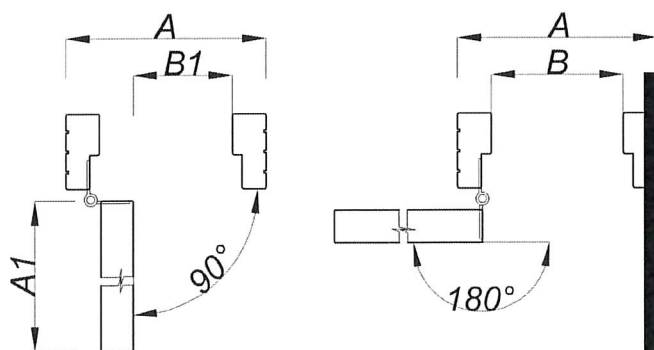

Declaration of performance

Producer: AS VILJANDI AKEN JA UKS, reg no 10052966, Puidu 6, 71020 Viljandi, Estonia

Hereby declares that

Product: internal door **FD30 (EI30)**

Product description: hinged timber leaf hung in timber frame, fire resistant wooden door.

Intended use or uses of the construction product: for closing entrances between the fire compartments of heated working and living premises.

Systems of assessment and verification of constancy of performance of the construction product: system 1

Produced: AS Viljandi Aken ja Uks, Piiri 2a, 71020, Viljandi, Estonia

Confirms with following characteristics:

No	Characteristics	Test or calculation standard	Classification standard	Unit	Class/ value	Test report	Notified body*
1.	Fire resistance	EN 1634-1	EN 13501-2	Class	EI,30	799-19TPU 839-20T2PU	1526

***Notified body:**

1526 – TÜV Eesti OÜ

- Products are produced according to standardisation proposal SFS 4434 in case it is not in conflict with European standards.
- Products are installed according to the product installation and maintenance instructions.
- "Warranty conditions for doors and windows sold by AS Viljandi Aken ja Uks" apply to the sale of products.

The Declaration of Conformity is established in accordance with Regulation 305/2011/EU.

AS Viljandi Aken ja Uks



Veiko Põldsaar
R&D Manager
25.01.2021

Certificate of conformity
ET-0246-19



Based on Estonian Regulation No. 49 of the Minister of Economic Affairs and Communications of 26.07.2013 „Requirements and procedure for attestation of the conformity for building materials and construction products” § 4, it has been stated that the construction product

Fire resistant door “EI30”. Sound insulation and fire resistant door “EI30”

placed on the market by

Viljandi Aken ja Uks AS

Puidu 6, 71012 Viljandi linn, Viljandi maakond, ESTONIA

and produced in the factory

Viljandi Aken ja Uks AS

Puidu 6, 71012 Viljandi linn, Viljandi maakond, ESTONIA

(Projektuksetehas Pärnu mnt 20, 71012 Viljandi linn, Viljandi maakond, ESTONIA)

is submitted by the manufacturer to a factory production control and to the further testing of samples taken at the factory in accordance with a prescribed test plan and that Inspecta Estonia OÜ has performed type testing, the initial inspection of the factory and of the factory production control and performs the continuous surveillance, assessment and approval of the factory production control.

This certificate attests that all provisions concerning the attestation of conformity and the performances described in Annex ZA of the standard

EN 16034:2014

were applied and that the product fulfils all the prescribed requirements.

This certificate is issued on **20.06.2019** and remains valid until **19.06.2024** as long as the conditions laid down in the standard in reference or the manufacturing conditions in the factory or the FPC itself are not modified significantly. The validity of the certificate can be checked on the Internet at www.kiwa.com/ee. Classification and field of direct application is presented in the technical description TS-ET-0246 Appendix Z.

German Vinas
Head of the conformity assessment department

Tallinn 20.06.2019



Inspecta Estonia OÜ
Teadusparki 8
12618 Tallinn
EESTI
Tel +372 659 9470
estonia@kiwa.com
www.kiwa.com/ee



Certificate No: ET-0246-19

Name and address of the sponsor: AS Viljandi Aken ja Uks, Puidu tn 6, 71020 Viljandi linn, Viljandi maakond, ESTONIA

Name and address of the producer: AS Viljandi Aken ja Uks, Puidu tn 6, 71020 Viljandi linn, Viljandi maakond, ESTONIA (Projektuksetehas Pärnu mnt 20, 71012 Viljandi linn, Viljandi maakond, ESTONIA)

Product: Fire resistant door "EI30". Sound insulation and fire resistant door "EI30".

Date: 10.06.2020, rev 01 10.06.2020

1. Essential characteristics and performance

Classification according to EN 13501-2:2016: EI₂30

Essential characteristics	Performance								
	E15	E20	E30	E45	E60	E90	E120	E180	E240
Resistance to fire	E ₁ 15	E ₁ 20	E ₁ 30	E ₁ 45	E ₁ 60	E ₁ 90	E ₁ 120	E ₁ 180	E ₁ 240
	E ₂ 15	E ₂ 20	E ₂ 30	E ₂ 45	E ₂ 60	E ₂ 90	E ₂ 120	E ₂ 180	E ₂ 240
	-	EW20	EW30	-	EW60	EW90	EW120	-	-
Smoke control	S _a					S ₂₀₀			
Self closing	C0	C1	C2	C3	C4	C5			

2. Product specification and field of application

Detail	max W, mm	max H, mm	max A, m ²
Leaf of single leaf doorset	1125	2145	2,41
Leaf of double leaf doorset	1025	2152	2,20
Thickness of the door leaf	40 mm		
Frame profile	(42/30 x 68) mm		
Wooden threshold profile if exists	(20/10 x 68) mm or (22/14 x 68) mm		

The mode of operation shall not be changed.

The thickness of the door leaf shall not be reduced but may be increased provided the total increase in weight is not greater than 25 %.

Decorative laminates and timber veneers up to 1,5 mm thickness may be added to the faces (but not the edges) of leaves.

On the edges of leaf 0,3 mm melamine edge band, 2,0 mm ABS plastic edge band or crepe framing element can be used on vertical edge.

The cross-sectional dimensions of the timber frames (including rebates) shall not be reduced but may be increased.

Doorset may be installed with wooden threshold, with drop seal Planet FT and RST threshold, with RST threshold only or in case of non-combustible flooring without threshold (gap at the lower edge of leaf ≤ 6 mm).

Sound insulation door may be installed only with wooden threshold.

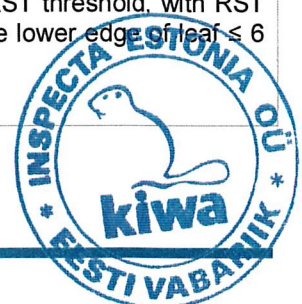

Sealing of the door leaf and frame	
Intumescent sealing (15 x 2,0) mm	On vertical frame members and on top frame member 1 strip, on lock edge of passive leaf of double leaf doorset 2 strips.
Silicone sealing Ø 8 mm if needed	On vertical frame members, on top frame member and on threshold if it exists, on double leaf doorset under astragal.

The use of silicone sealing is mandatory only for sound insulation door.

Hardware	
Lock + Striking plate	ASSA 565 + ASSA 2864-2; Abloy 2014 + Abloy 0033; ASSA 410-50 + ASSA 1487-2
Hinges /3 pcs per leaf/	concealed hinge Otlav IN300120; concealed hinge Otlav IN230120; ASSA 3248-01 FOP; Abloy 3248-110 TMKSS
Closer	Dorma TS 73V
Flush bolt /2 pcs on passive leaf/	automatic flush bolt Olda 33 HZA-R32F; manual flush bolt Olda 33 HZM-R32
Door viewer	Amig 180
Lead cover	Abloy EA281

Distance between the centre of the upper hinge and edge of door leaf is 100-250 mm. Distance between the centre of the lower hinge and edge of door leaf is 100-262 mm. Max step 1395 mm.

The height of lock is 1025 ± 200 mm from the lower edge of leaf.

If self-closing characteristics are not required, the doorset may be installed without door closing device.

3. General field of application

Doorset may be mounted in standard high density rigid, in standard low density rigid and in standard flexible supporting construction.

Allowed installation gap ≤ 25 mm in case of single leaf door and ≤ 20 mm in case of double leaf door may be sealed with mineral wool, with fire rated PU foam or using combined sealing with wool and foam.

The door leaf and the door frame may be painted.



NDVK

NORWEGIAN DOOR-AND
WINDOW-CONTROL

CERTIFIED

Certificate

It's confirm that

Viljandi Aken ja Uks AS, Doorfactory Estonia

Fulfil the requirements according to
NORWEGIAN DOOR- AND WINDOW CONTROL

NDVK-Rules

The certificate include all production of windows and doors,
and include the following products:

Door types:

- VU T1 HPL, outward opening timberdoor, with or without glazing.
- VU T1, outward opening timberdoor, with or without glazing.
- FD 14, one sided hinged timber leaf in timber frame, external door.

Oslo date: 05.03.2021



NDVK chairman

Date of issue first time: 02.01.201
Valid thru: 31.12.2021

Certificate NO.: 061

NDVK

NORWEGIAN DOOR-AND
WINDOW-CONTROL

CERTIFIED

Quality management in the production of windows and door fulfils the requirement to **NDVK Rules:**

Requirements for doors and windows of 01/2019

and

Rules for certificate and inspection of 01/2019.

The product at page 1 fulfil the requirement according to:

Characteristic	Classification/value										NDVK req.
Air permeability											
Class	1		2			3		4			4
Max. test pressure (Pa)	150		300			600		600			
Watertightness											
Class - Non-shielded (A)	1 A	2 A	3 A	4 A	5 A	6 A	7 A	8 A	9 A	E	7A or 7B*
Test pressure (Pa)	(0)	(50)	(100)	(150)	(200)	(250)	(300)	(450)	(600)	(>600)	
Class - Shielded (B)	1 B	2 B	3 B	4 B	5 B	6 B	7 B				
Test pressure (Pa)	(0)	(50)	(100)	(150)	(200)	(250)	(300)				

* Requirement for windows and balcony-doors

** Requirement for Pedestrian doors