

Type : Mercury and Lead Free Button Cell
Chemical System : Zinc/Manganese Dioxide
Nominal Voltage : 1.5V
Nominal Dimension : $\Phi 11.6 \times 5.4\text{mm}$
Applications : Calculator, hearing, lighter, camera,...etc.
Average Weight : 1.9g
Date Code : Unless otherwise specified, each cell will carry a numeric year code and an alphabetical month code.
Close Voltage **Circuit** : 1.3V(min.)(load resistor 100 Ω at 20°C for 0.1 to 2 seconds)

Model No.: **GPA76F**

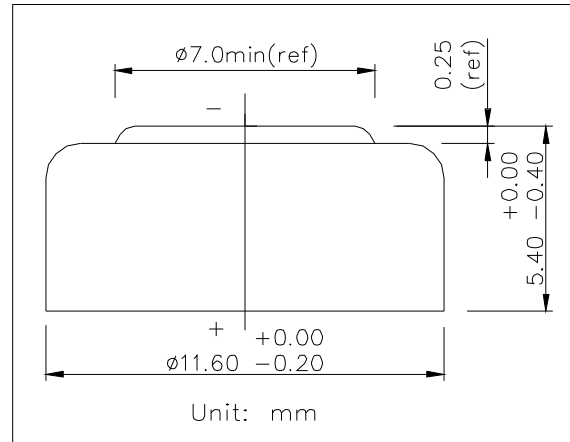

Nominal Life **Service** : 140hrs (load 1.6k Ω to cut off 1.0V under 20°C)
Average Capacity **Service** : 110mAh (load 1.6k Ω to cut off 1.0V under 20°C)

Cross References:

IEC	Maxell	Duracell	Others
-----	--------	----------	--------

LR44	LR44	PX76A	V13GA, AG13
------	------	-------	-------------

Typical discharge curve when at 20 ± 2 °C

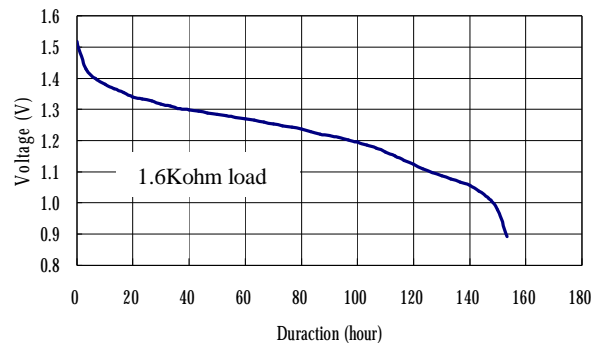

Typical Discharge characteristics at 20 ± 2 °C

The information (subject to change without prior notice) contained in this document is for reference only and should not be used as a basis for product guarantee or warranty. For applications other than those described here, please consult your nearest GP Sales and Marketing Office or Distributors.

BQS1051 rev.02

www.gpbatteries.com

Manufacturer reserves the right to alter or amend the design, model and specification without prior notice.
Copyright©GPI International Ltd. – All rights reserved

 **Member**
Gold Peak Group