

Beam clamp TKR 31

Clamping bracket for the fixing of channels to steel girders



Channel fixing to steel beam

Applications

- Fixing of FLS channels to steel girders, required are two beam clamps per fixing.

Advantages/Benefits

- The design of the beam clamp allows for fixing without drilling or welding.
- The various lengths of the beam clamp sides allows for fixing on all standard steel beams.
- The shape of the beam clamp guarantees the simple adjustment of the channel connection.

Properties

- Material U-bolt pipe hanger: steel S235 JR (material no.: 1.0037) acc. DIN EN 10025-2
- Material plate: steel E295 (material no.: 1.0050) acc. DIN EN 10025-2
- Material hexagon nut: steel resistance class 8
- Zinc plating: electro zinc-plated, min. 5 µm acc. DIN EN ISO 4042

Technical data

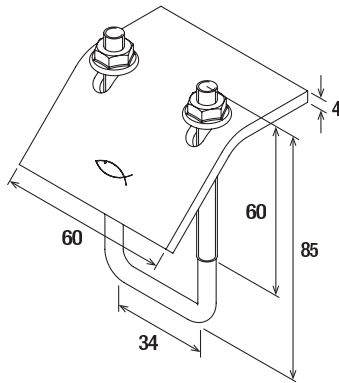

TKR 31

Item	Item No.	Thread A	Width across nut SW [mm]	Sales unit [pcs]
TKR 31	538751	M 6	10	25

Loads

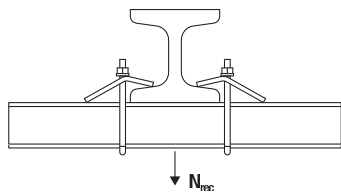

TKR

Item	Item No.	Max. recom. static load (centr. tension) $N_{recom.}$ [kN]	Tightening torque T_{inst} [Nm]
TKR 31	538751	2.80	5