

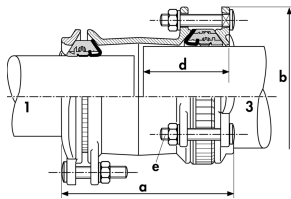

MULTI/JOINT® 3000 Plus Wide Range Coupling, non restraint

Model:

- Suitable for all kinds of pipe material
- Suitable for water and gas
- Ductile cast iron GGG45 body and clamping ring(s), acc. to EN-GJS-450-10
- RESICOAT® epoxy powder coating, according to GSK standards and EN 14901
- NBR or EPDM gasket, NBR acc. to EN 682 (-5°C up to +50°C), EPDM acc. to EN 681-1 (0°C up to +50°C)
- Angular deflection of max. 8° per socket at installation (based on the middle of the range)
- Stainless steel A2 quality (AISI 304) or A4 quality (AISI 316) bolts, nuts and washers
- For all plastic pipes, the use of an insert stiffener (see accessories) is recommended and in some cases mandatory. Check our technical information.
- Hygiene protection included DN50 - DN600



| DN (mm) | Range 1 (mm) | Range 3 (mm) | NBR / A2 Code | EPDM / A2 Code | NBR / A4 Code | EPDM / A4 Code | Weight (kg) |
|------------|-----------------|-----------------|------------------|-------------------|------------------|-------------------|----------------|
| 50 | 46 - 71 | 46 - 71 | 709 301 210 | 709 301 610 | 709 301 010 | 709 301 310 | 4.800 |
| 65 | 63 - 90 | 63 - 90 | 709 301 212 | 709 301 612 | 709 301 012 | 709 301 312 | 5.600 |
| 80 | 84 - 105 | 84 - 105 | 709 301 214 | 709 301 614 | 709 301 014 | 709 301 314 | 7.200 |
| 100 | 104 - 132 | 104 - 132 | 709 301 216 | 709 301 616 | 709 301 016 | 709 301 316 | 9.400 |
| 125 | 132 - 155 | 132 - 155 | 709 301 218 | 709 301 618 | 709 301 018 | 709 301 318 | 12.000 |
| 150 | 154 - 192 | 154 - 192 | 709 301 220 | 709 301 620 | 709 301 020 | 709 301 320 | 14.800 |
| 200 | 192 - 232 | 192 - 232 | 709 301 224 | 709 301 624 | 709 301 024 | 709 301 324 | 28.600 |
| 225 | 230 - 268 | 230 - 268 | 709 301 226 | 709 301 626 | 709 301 026 | 709 301 326 | 33.400 |
| 250 | 267 - 310 | 267 - 310 | 709 301 228 | 709 301 628 | 709 301 028 | 709 301 328 | 40.000 |
| 300 | 315 - 356 | 315 - 356 | 709 301 232 | 709 301 632 | 709 301 032 | 709 301 332 | 51.500 |
| 350 | 352 - 393 | 352 - 393 | 709 301 236 | 709 301 636 | 709 301 036 | 709 301 336 | 61.200 |
| 400 | 392 - 433 | 392 - 433 | 709 301 240 | 709 301 640 | 709 301 040 | 709 301 340 | 73.200 |
| 425 | 432 - 464 | 432 - 464 | 709 301 242 | 709 301 642 | 709 301 042 | 709 301 342 | 91.300 |
| 450 | 450 - 482 | 450 - 482 | 709 301 272 | 709 301 672 | 709 301 072 | 709 301 372 | 97.600 |
| 475 | 481 - 513 | 481 - 513 | 709 301 273 | 709 301 673 | 709 301 073 | 709 301 373 | 98.300 |
| 500 | 500 - 532 | 500 - 532 | 709 301 274 | 709 301 674 | 709 301 074 | 709 301 374 | 105.400 |
| 550 | 548 - 580 | 548 - 580 | 709 301 276 | 709 301 676 | 709 301 076 | 709 301 376 | 114.900 |
| 600 | 605 - 637 | 605 - 637 | 709 301 278 | 709 301 678 | 709 301 078 | 709 301 378 | 136.100 |

| DN (mm) | a (mm) | b (mm) | d (mm) | e (mm) | PN Water (bar) | PN Gas (bar) |
|------------|-----------|-----------|-----------|-----------|-------------------|-----------------|
| 50 | 209 - 233 | 164 | 95 | 3xM12 | 25 | 8 |
| 65 | 220 - 250 | 186 | 100 | 3xM12 | 25 | 8 |
| 80 | 234 - 262 | 204 | 115 | 3xM12 | 25 | 8 |
| 100 | 230 - 268 | 236 | 110 | 3xM16 | 25 | 8 |
| 125 | 246 - 282 | 264 | 120 | 4xM16 | 25 | 8 |
| 150 | 242 - 298 | 304 | 120 | 4xM16 | 25 | 8 |
| 200 | 297 - 351 | 354 | 140 | 6xM16 | 25 | 8 |
| 225 | 342 - 404 | 386 | 145 | 6xM20 | 25 | 8 |
| 250 | 354 - 424 | 432 | 170 | 6xM20 | 25 | 8 |
| 300 | 356 - 426 | 490 | 170 | 8xM20 | 25 | 8 |
| 350 | 504 - 588 | 534 | 245 | 8xM20 | 25 | 8 |
| 400 | 562 - 648 | 574 | 275 | 10xM20 | 25 | 8 |
| 425 | 530 - 580 | 623 | 275 | 10xM20 | 16 | 8 |
| 450 | 530 - 580 | 641 | 275 | 10xM20 | 16 | 8 |
| 475 | 530 - 580 | 672 | 275 | 10xM20 | 16 | 8 |
| 500 | 530 - 580 | 691 | 275 | 10xM20 | 16 | 8 |
| 550 | 530 - 580 | 739 | 275 | 12xM20 | 16 | 8 |
| 600 | 530 - 580 | 796 | 275 | 14xM20 | 16 | 8 |

Data sheet

valid from: 4/10/18



The technical data are not binding. They neither constitute expressly warranted characteristics nor guaranteed properties nor a guaranteed durability. They are subject to modification. Our General Terms of Sale apply.

Georg Fischer Piping Systems Ltd, Postfach, CH-8201 Schaffhausen/Switzerland

Phone +41 -(0)52-631 1111

e-mail: info.ps@georgfischer.com

Internet: <http://www.gfps.com>