

Description	: Flat Lithium Battery
Chemical system	: Lithium Manganese
Nominal voltage	: 3 Volts
Nominal capacity	: 90mAh
Dimensions	: Ø20mm x 1.6mm
Shelf life	: 10 years at room temperature
Average weight	: 1.5 grams
Operation temperature:	-20°C ~60°C
Storage temperature:	20°C ± 2°C

Cross References:

IEC	JIS	Panasonic	Varta
CR2016	CR2016	CR2016	CR2016

Discharge Characteristics

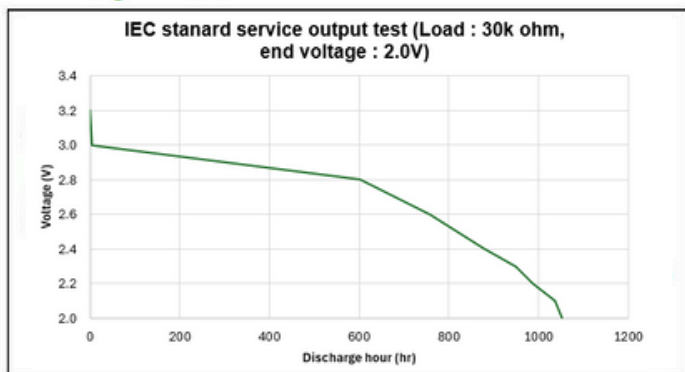

Model no.: **CR2016**

Ultra+
LITHIUM

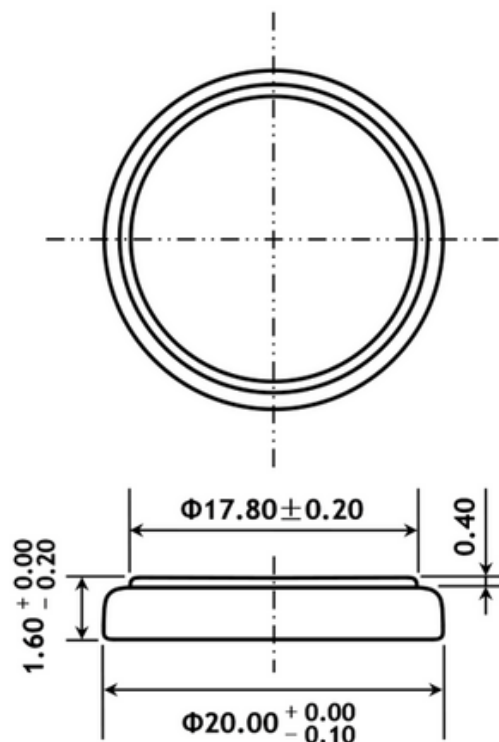

The information (subject to change without prior notice) contained in this document is for reference only and should not be used as a basis for product guarantee or warranty. For applications other than those described here, please consult your nearest GP Sales and Marketing Office or Distributors.