

# HVAC Insulation

This product sheet describes our HVAC insulation boxes for heating applications.

SWEP accessories meet the same high standards as the company's BPHEs. They are produced according to SWEP's specification by rigorously selected suppliers. The high-quality materials are carefully chosen for compatibility, while the accurate dimensions save you time and money on installation. With SWEP accessories you have the assurance that everything will fit and perform the way the design engineers intended.

For more information, please contact your local SWEP representative.

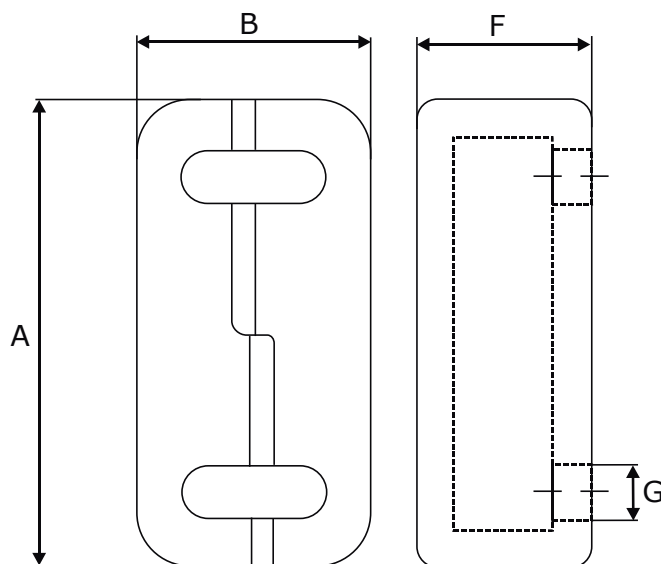

Technical data	
Max operating temperature	130°C
Color	Red
Thermal conductivity	0.032 W/mK
Fire properties	B2 in accordance with DIN4102 T2
Insulation material	Rigid expanded polyurethane
Cover material	Polystyrene 475K

Size	5T	8T	10T/12	15	16/26	25T/28/80
A (mm)	246	386	356	530	452	594
B (mm)	119	127	181	126	185	182
F (mm)* approx.	66+2.2×NoP	77+2.24×NoP	72+2.24×NoP	66+2.5×NoP	85+2.25×NoP	84,3+2,4×NoP
G (mm)	35	35	50	35	45	50
Thickness (mm)	20	25	30	25	25	30

\*Only available in selected 10th NoP (for example 10, 20, 30, etc). NoP = Number of Plates

Size	35	50/56/120T/200T	65	427
A (mm)	495	627	1073	850
B (mm)	330	330	500	418
F (mm)* approx.	105,1+2,4×NoP	105,1+2,4×NoP	178+2,4×NoP	154,5+2,3×NoP
G (mm)	68	85	123	173
Thickness (mm)	40	40	60	60

\*Only available in selected 10th NoP (for example 10, 20, 30, etc). NoP = Number of Plates

[www.swep.net](http://www.swep.net)

**SWEP**  
A DOVER COMPANY