

## Note on English translation / Hinweise zur englischen Fassung

This is a translation of the technical data sheet valid in Germany.

All stated details and properties are in compliance with the regulations of the German standards and building regulations. They are only applicable for the specified products, system components, application rules, and construction details in connection with the specifications of the respective certificates and approvals.

Knauf Gips KG denies any liability for applications outside of Germany as this requires changes acc. to the respective national standards and building regulations.



E141.de

Drywall Systems

2012-05

# Knauf alutop Access Panel F-TEC Airtight / Dust-proof and Smoke-proof

Universal application in drywall partitions, furrings, solid walls and suspended ceilings without fire resistance

For cladding thickness up to 30 mm

## Product description

Airtight, dust-proof and smoke-proof access panel (airtight and dust-proof class 4, DIN EN 1026+12207, suction and pressure / smokeproof following DIN 18095) for the installation in walls (drywall partitions, furrings, solid walls) and in suspended ceilings. Suitable for cladding thicknesses of up to 30 mm, consisting of

- an anodised aluminium frame with openable and fully detachable hatch
- flush bonded face board made of Knauf Diamant (for standard sizes)
- seal
- self-activating drop catch

## Product range

- F-TEC Airtight / Dust-proof and Smoke-proof for 12.5 / 18 / 25 / 30 mm cladding thickness

## Additional options / special designs

- Intermediate dimensions
- Four-square bolt
- Round cylinder lock
- Lock designed for profile cylinder
- Prepared for surface quality Q4 (on-site)
- Prepared for on-site tiling

## Properties

- One type for ceilings and walls and for 4 different cladding thicknesses
- Flush bonded Diamant face board, i. e. no filling is required for the hatch
- Small opening displacement of the lock and low installation depth in the cavity
- Suitable for subsequent installation in finished walls/ceilings
- Standard type is also suitable for installation in solid walls
- Accurately fitting with tiling in sanitary facilities

# E141.de Knauf alutop Access Panel F-TEC Airtight / Dust-proof and Smoke-proof **KNAUF**

Universal application in drywall partitions, furrings, solid walls and suspended ceilings without fire resistance



## Installation in Knauf Ceiling Systems

Scheme drawings - Dimensions in mm

**E141.de-V1** Example: 12.5 mm cladding thickness

**Size - 35 mm**  
= clearance

**Notes**

- Observe the enclosed installation instructions for the access panel
- Installation of
  - Ceiling systems
  - Wall systems
  - Furring systems
 acc. to Knauf Technical Data Sheet

Vertical section

## Installation in Knauf Partition / Furring Systems

**E141.de-V2** Example: Partition system with 12.5 mm cladding

Vertical section

## Possible cladding thicknesses

■ **F-TEC Airtight / Dust-proof and Smoke-proof**

- 12.5 mm
- 18 mm
- 2x 12.5 / 25 mm
- 2x 15 mm

Metal tabs

## Installation in solid walls

**E141.de-V3**

Vertical section

Cladding thickness	Sizes (w x h)	Weight
mm	mm	kg/piece
■ 12.5	■ 300 x 300	approx. 2.5
■ 18	■ 400 x 400	approx. 3.8
■ 2x 12.5 / 25	■ 500 x 500	approx. 5.2
■ 2x 15	■ 600 x 600	approx. 7.0
	■ 700 x 700	approx. 13.5
	■ 800 x 800	approx. 15.8
	Customized sizes on request	

Equipment options	
Intermediate dimensions <sup>3)</sup>	■
Designed for on-site tiling	■
Prepared for surface quality Q4	■
Four-square bolt lock	■
Round cylinder lock	■
Lock designed for profile cylinder	■

1) Distance to basic ceiling / installations

Opening displacement clearance of the access panel

3) Size min. 300 x 300 mm; max. 800 x 800 mm

■ Approved airtightness up to 600 Pascal, overpressure or underpressure

## Examples (Scheme drawings)

### Installation in Knauf Ceiling Systems

#### Additional substructure

- 4 additional suspensions (e.g. Nonius Suspension)
- Alternative suspension points

Universal connectors are required for the trimmings.  
If suspended channels need to be cut and replaced by an additional trimmer channel, additional suspenders are necessary

#### ■ Double-level metal grid (e.g. D112.de)

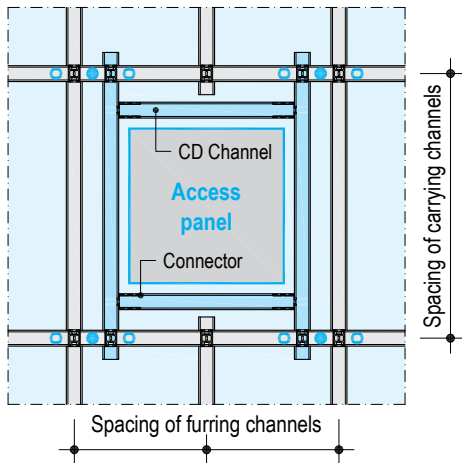

#### ■ Flush metal grid (e.g. D113.de)

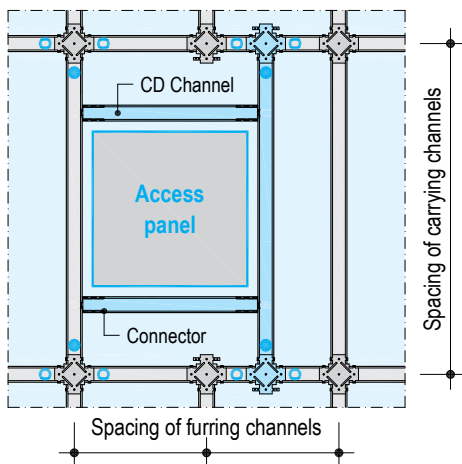

### Installation in Knauf Partition / Furring Systems

#### Additional substructure or trimming

Depending on the type and installation situation of the access panels, trimmer profiles or frames made of profiles are necessary.

#### Subsequent installation in walls is necessary

If the installation of the access panel is performed at a later time, the cladding is sawed out. Apply frame made of circumferential profile pieces (UW or CW) and screw attach (screw spacing  $\leq 150$  mm).

#### ■ Stud spacing -a- continuous

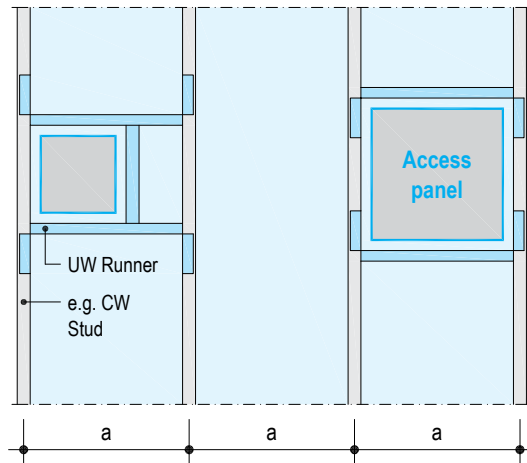

#### ■ Stud spacing -a- with cut stud and trimmer profiles

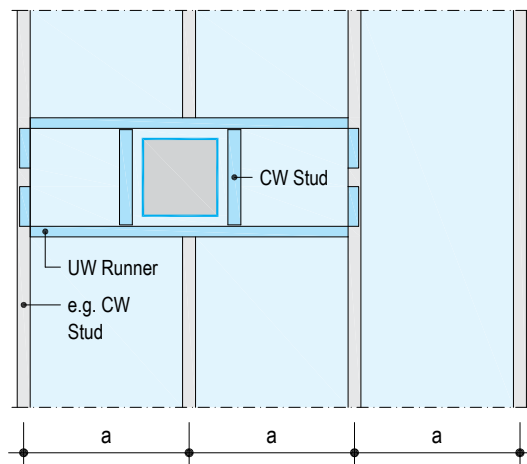

# E141.de Knauf alutop Access Panel F-TEC Airtight / Dust-proof and Smoke-proof

Universal application in drywall partitions, furrings, solid walls and suspended ceilings without fire resistance

## Order information

### Required specifications for ordering:

- Size of the access panel (w x h)
- Mounting component, e.g., ceiling, partition....
- Additional options: see page 2
- Access panels for tiling:  
Specify tile dimensions, joint width, adhesive thickness, tile thickness and cladding thickness. The exact clearance is determined through the tile format.

## Construction

Select access panels considering cladding thickness of the Knauf systems. Knauf alutop Access Panels consist of a firm outer aluminium frame, and an openable and fully detachable hatch. F-TEC Airtight / Dust-proof and Smoke-proof are equipped with flush bonded face board made of Knauf Diamant hard gypsum board. Outer frame and hatch of the access panels are reinforced on the rear side using corner connectors. The hatch is fixed flush with the outer frame using special Knauf alutop locks and hinge brackets. A joint width of only approx. 1.5 mm is visible between the outer frame and the hatch when fully mounted.

With rectangular ceiling access panels, the lock and hinge system is always mounted on the long side. With access panels for partitions the lock is always on top while the hinges are on the bottom side.

Installation requires additional substructure or trimmer profiles. The access panels are suitable for subsequent installation in finished walls/ceilings.

The use of round cylinder or profile cylinder locks and four-square bolting is optional.

## Installation

Installation of access panels as per accompanying application instructions, installation of Knauf Systems in accordance with relevant current Knauf Technical Data Sheets. Use drywall screws TB for the attachment of the frame to the cladding (two screws per metal tab). CAUTION: The required length of the screws is determined by the cladding thickness. Apply at least 1 metal tab per frame side (2 on the lock side) for panel size  $\leq 400 \times 400$  mm, at least 2 per frame side for panel size  $\leq 600 \times 600$  mm and at least 3 per frame side for panel size  $\leq 800 \times 800$  mm. No board joints of the cladding are allowed near the access panels.

With wall access panels, a clearance of  $\geq 50$  mm must be ensured in the upper third of the rear side of the hatch for opening the panel. It is possible to install the access panel at the same time as the substructure or after the cladding application. Cut out opening 20 mm (18 mm in solid walls) larger than the access panel size (Size - 35 mm = clearance).

Install additional trimmers made of CD, CW or UW profiles based on the dimensions of the access panel, maintain distances between cutout section and trimmer profiles of  $\geq 25$  mm and  $\leq 100$  mm. Mount 4 additional suspenders in the corner are-

as of the access panel in ceilings. More additional suspenders are required for replacing suspended ceiling profiles.

Place outer frame of the access panel in the opening, lay it on the cladding, align and screw attach. Subsequently insert hatch and check lock for proper functioning. If the distance to the installations in the wall or ceiling is  $< 200$  mm, it is necessary to perform the installation of the outer frame in the gypsum board before the cladding.

- Refer to the enclosed installation instructions.

## Jointing

Fill outer frame of access panel and the ceiling/wall surface fully with Uniflott. It is not necessary to fill or skim the hatch face when using in case of flush bonded gypsum boards and surface quality Q2. For surface quality level Q3: Scrape skim hatch face. Preparation for quality level Q4 on request. Clean outer frame, hatch, and particularly seal thoroughly after filling. Installation in solid walls: Mount outer frame with plaster.

## Surface treatment

For surface treatment of the access panels with gypsum board face follow Knauf Technical Data Sheet for the respective system.

### Note for access panels prepared for painting:

Tile application is only permissible with thin-bed method. Fill joint between cladding and outer frame after installation of the access panel. The edge of the wall tile can be directly applied on the clearance dimension. Install seal (included).

### Note for the painter

Generally remove the access panel hatch before coating and paint separately so that no paint penetrates the narrow joint between the hatch and the outer frame. Thoroughly clean outer frame, hatch, and particularly the seals.

See [www.knauf.de](http://www.knauf.de) - Technical Data Sheets:

- E143.de Knauf alutop Revisionsklappe F-TEC Driving Rain-Proof
- E144.de Knauf alutop Revisionsklappe F-TEC Disinfectant-resistant

## Knauf Direct

Technical Advisory Service:

▶ Phone.: +49 9001 31-1000 \*

▶ Fax: +49 1805 31-4000 \*\*

▶ [www.knauf.de](http://www.knauf.de)

Knauf Gips KG Am Bahnhof 7, 97346 Iphofen, Germany

\* Call rates to Knauf Direct from within the German landline network: 0.39 € per Min., Callers whose phone numbers are not registered in the Knauf address database, e. g. private builders or non-patrons are charged 1.69 €/Min. Calls from mobile phones may differ and will be charged acc. to net provider and call rate.

\*\* Fax: 0.14 €/Min. within the German landline network

All technical changes reserved. Only the current printed instructions are valid. Our warranty is expressly limited to our products in flawless condition. All application quantities and delivery amounts are based on empirical data that are not easily transferable to other deviating areas. The stated information represents current state-of-the-art Knauf technology. The entire state of approved engineering rules, appropriate standards, guidelines, and rules of craftsmanship are not included herewith. These and all application instructions have to be adhered to separately by the installer.

All rights reserved. All amendments, reprints and photocopies, including those of excerpts, require the express permission of Knauf Gips KG, Am Bahnhof 7, 97346 Iphofen, Germany. Delivery via professional building material distributors only, in accordance with our current business, delivery and payment terms.