



SCALA2



<http://qr.grundfos.com/i/scala2install>

be
think
innovate

GRUNDFOS 

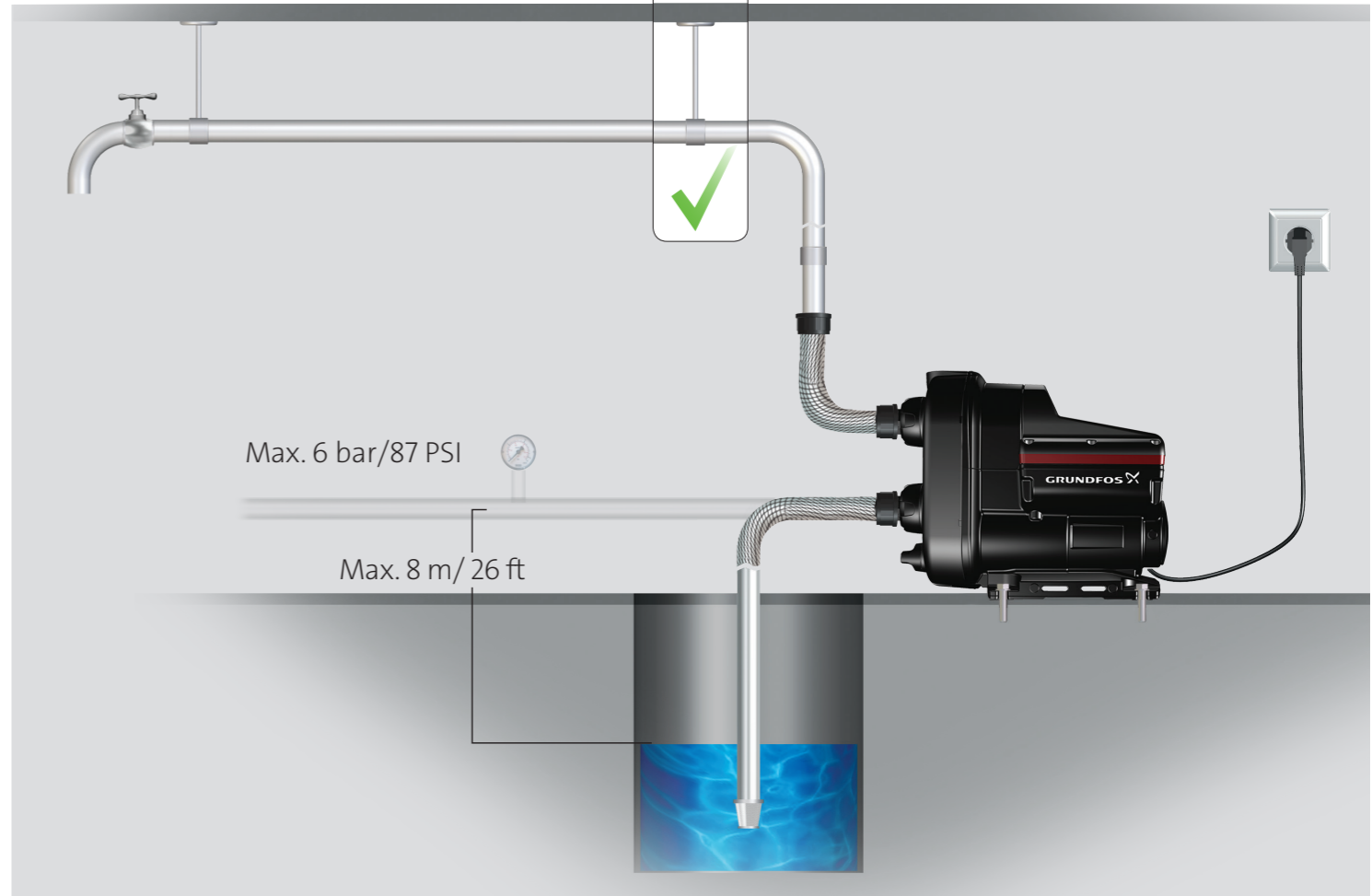
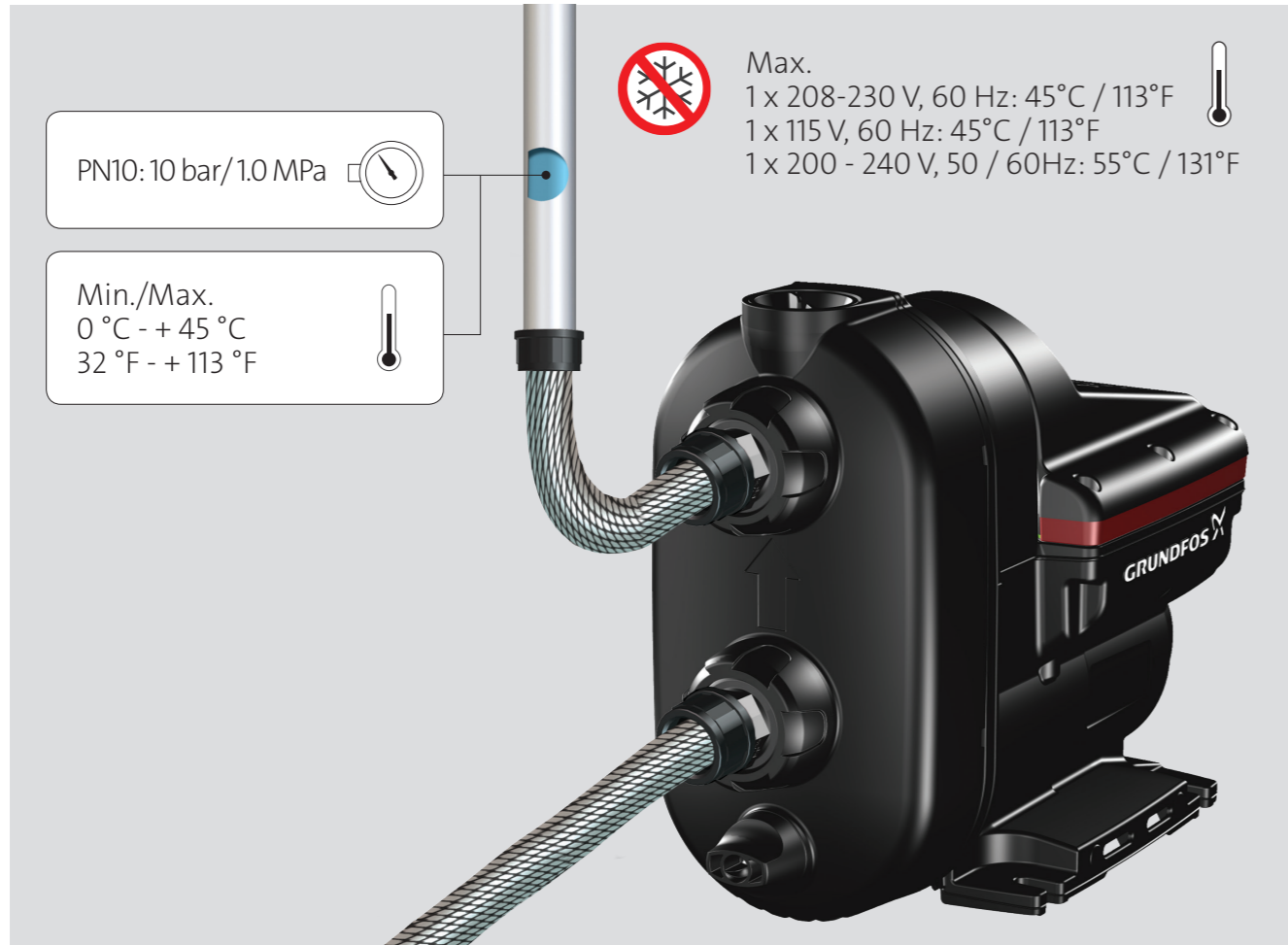
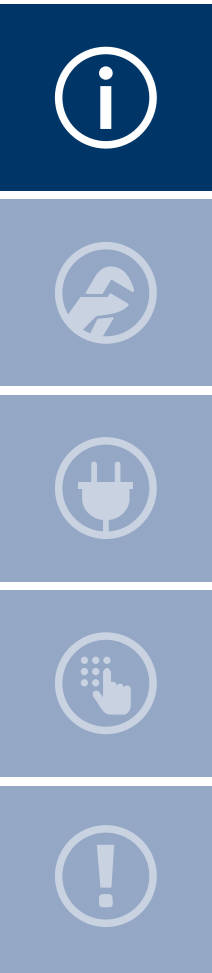

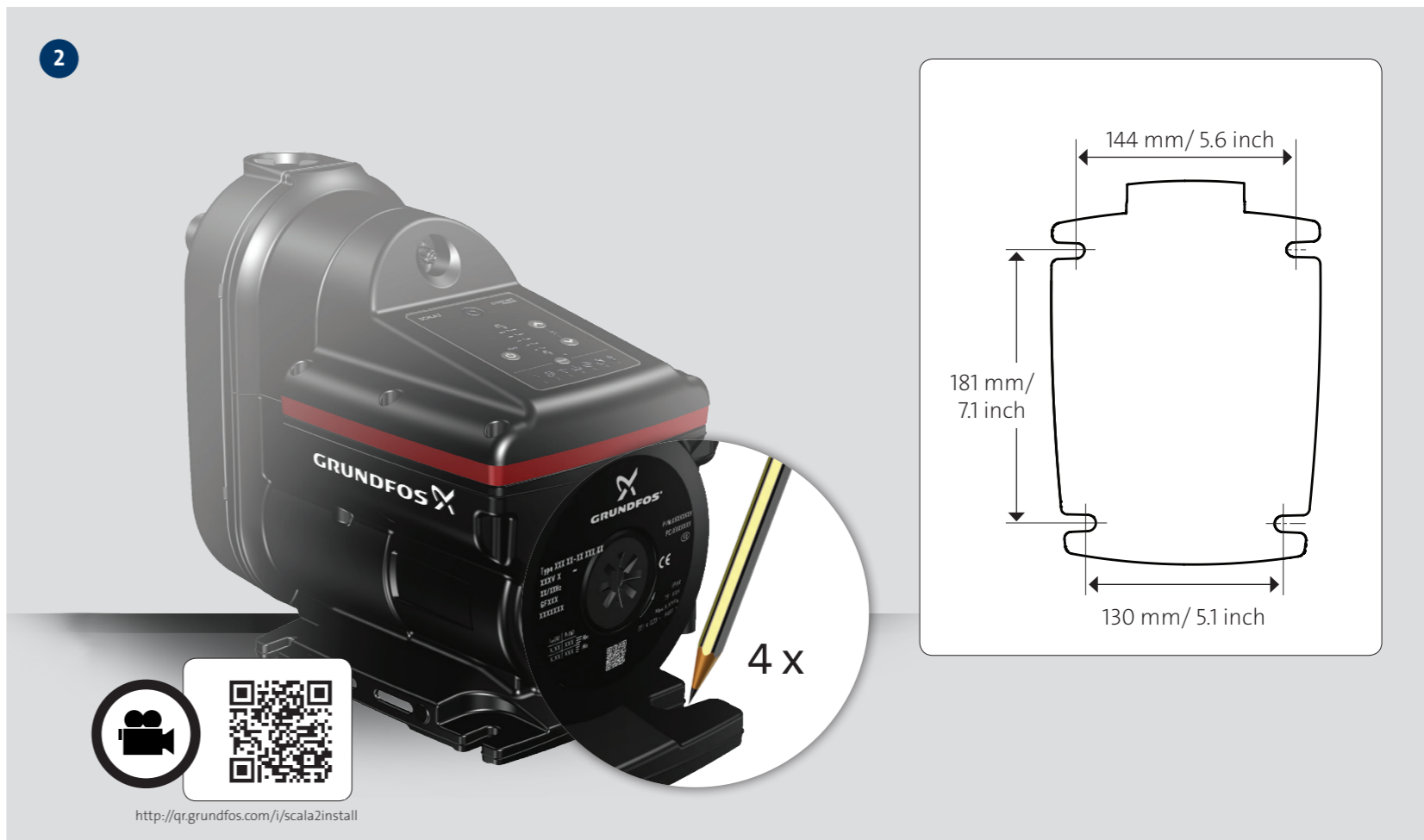
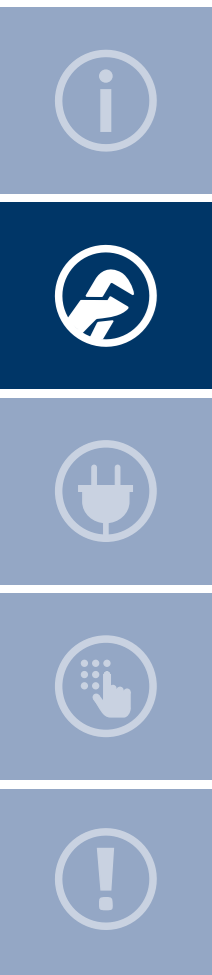

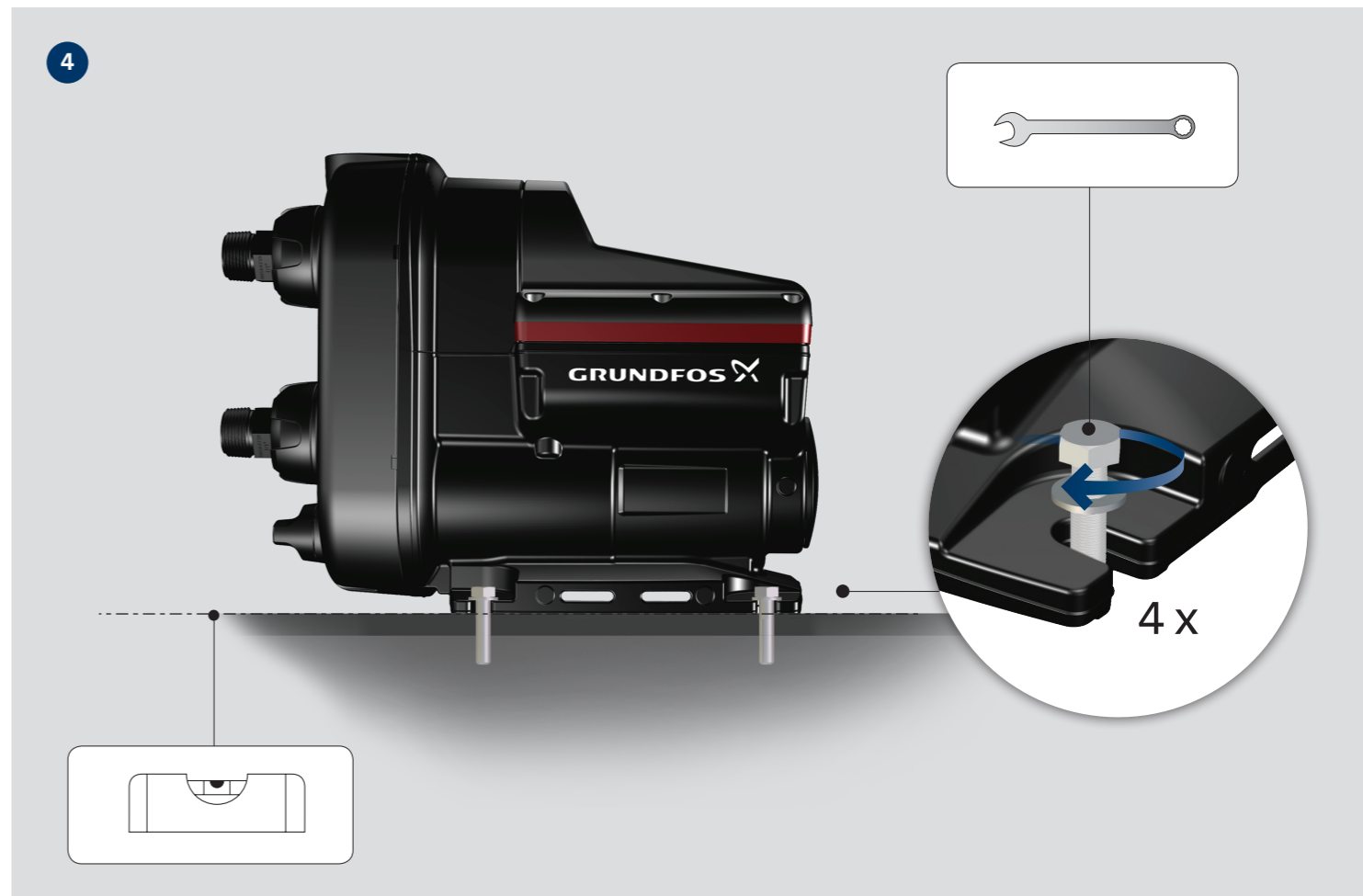
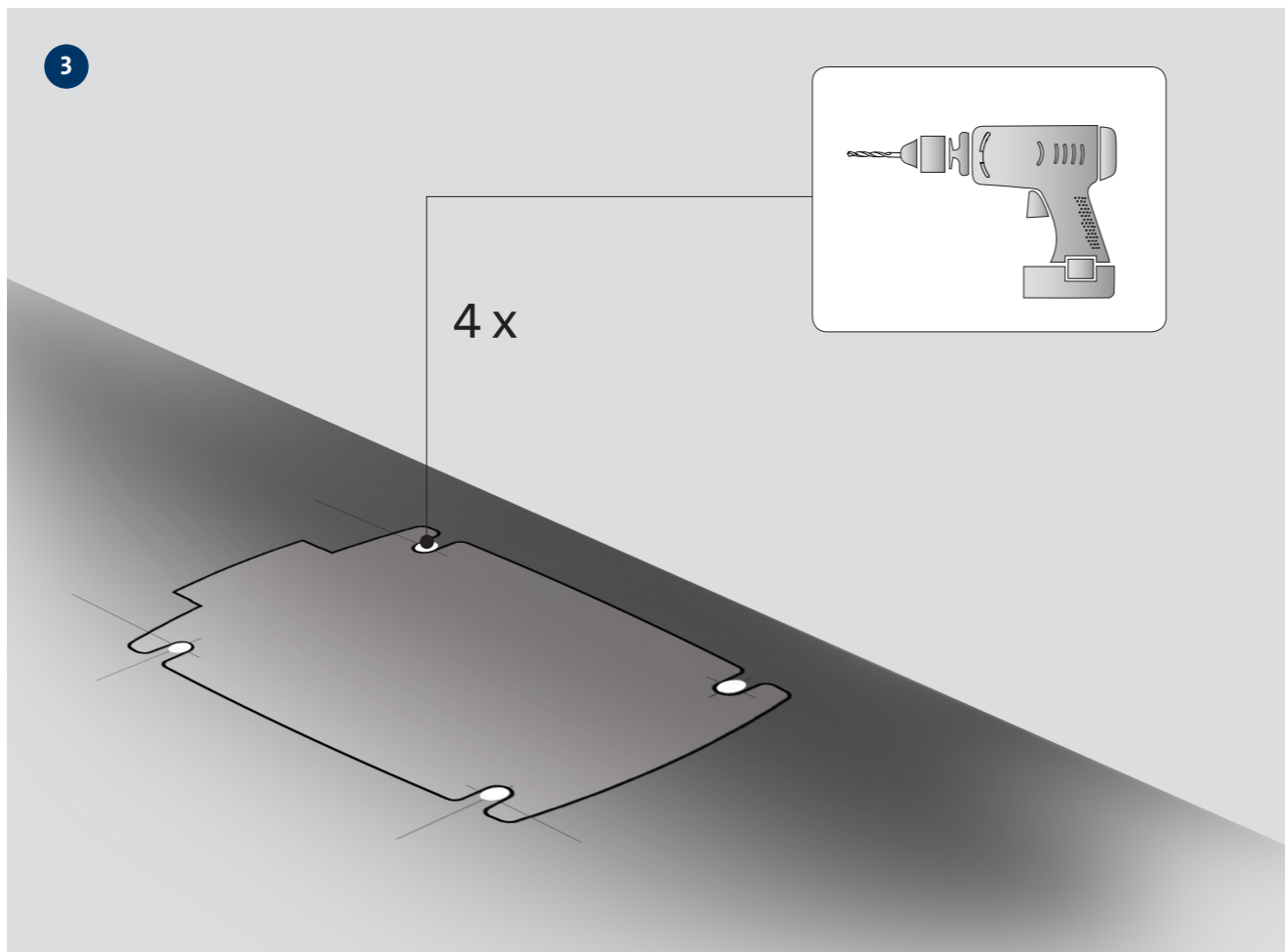
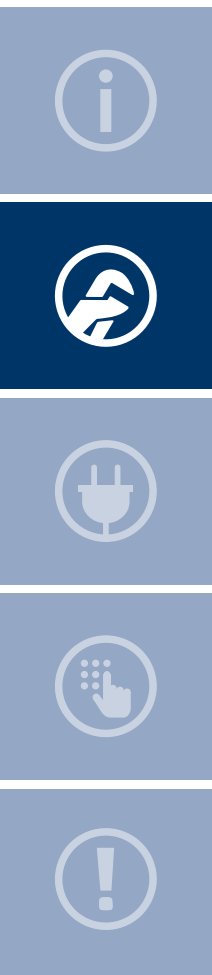

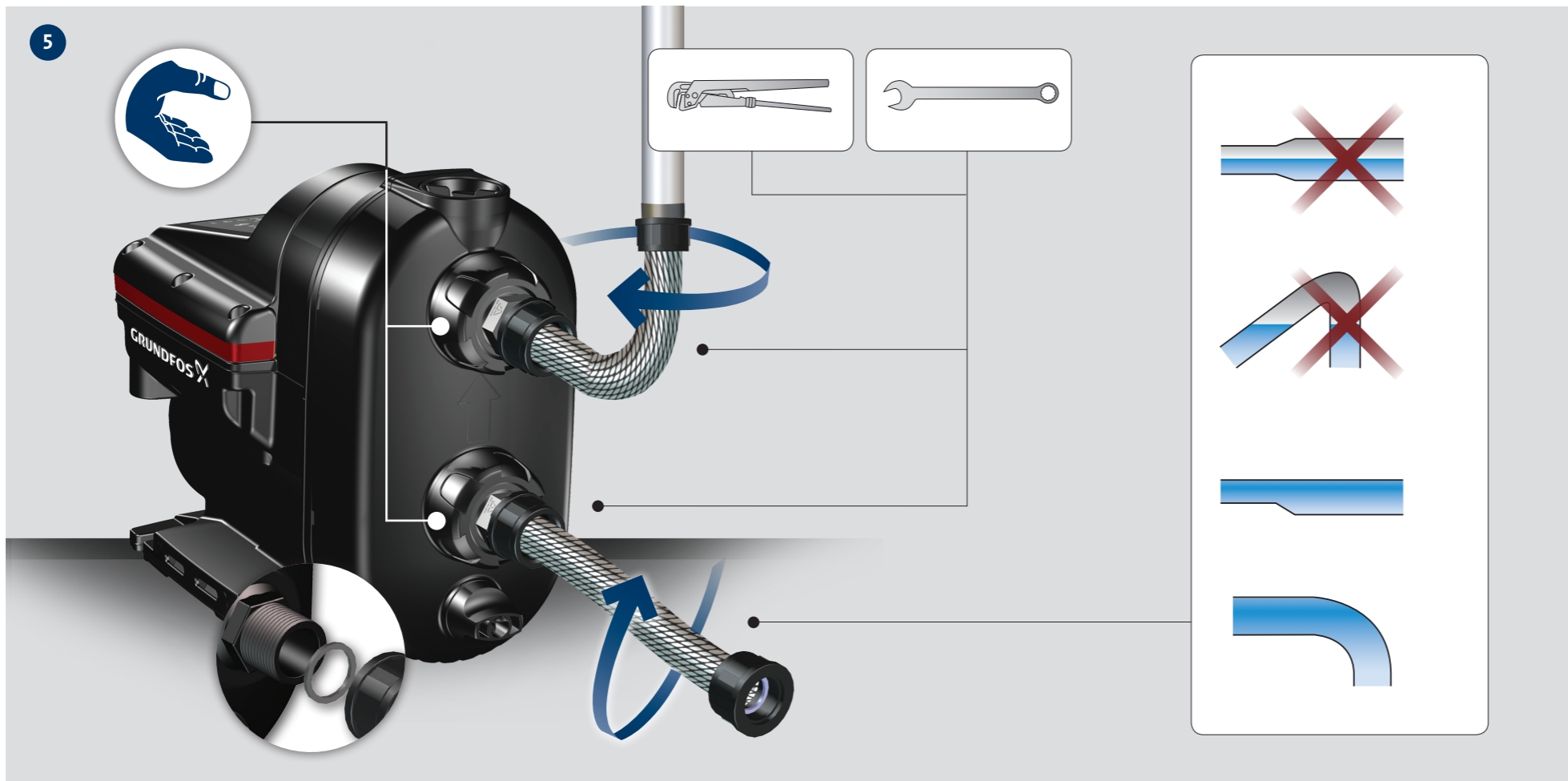
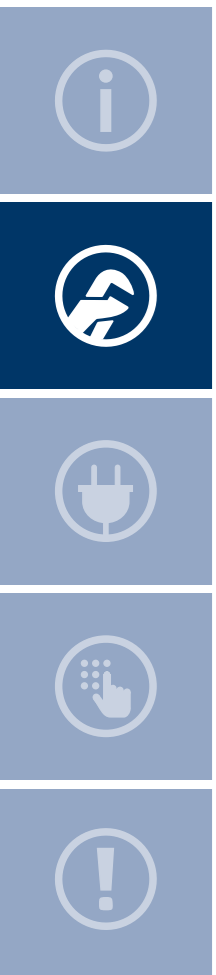

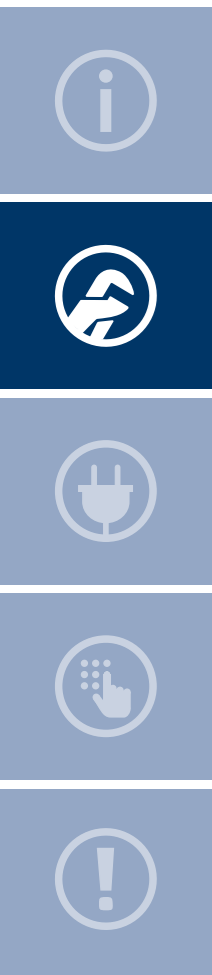

6

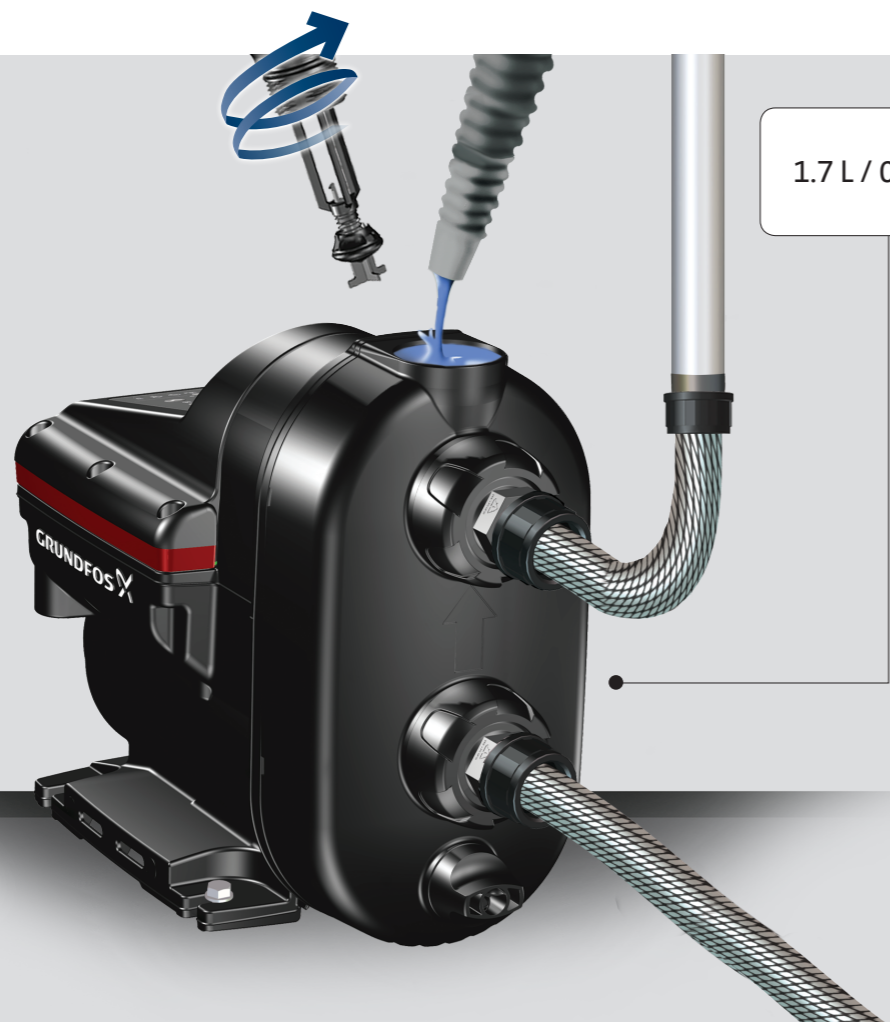

1.7 L / 0.45 gal



<http://qr.grundfos.com/i/scala2install>

7



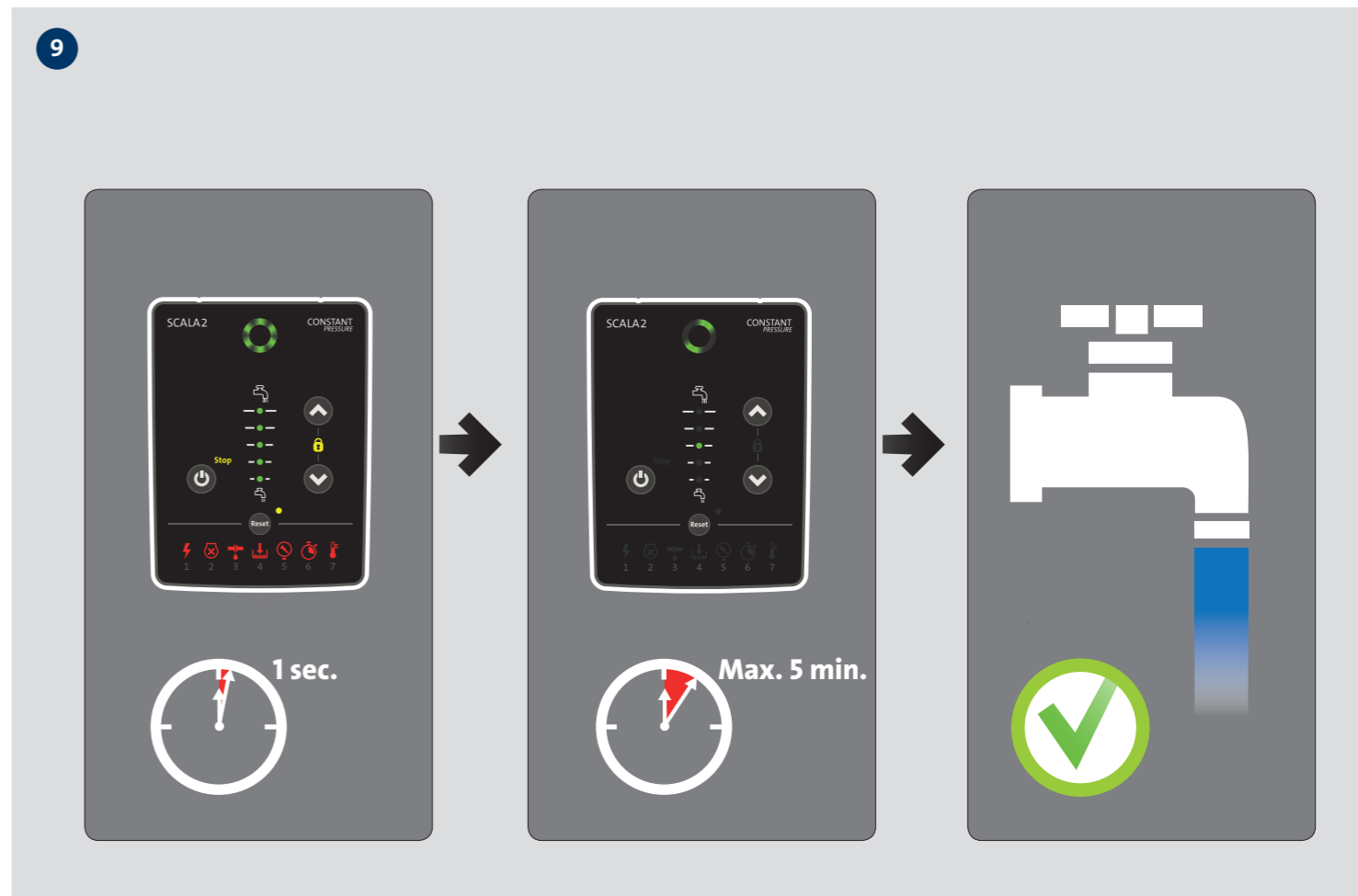
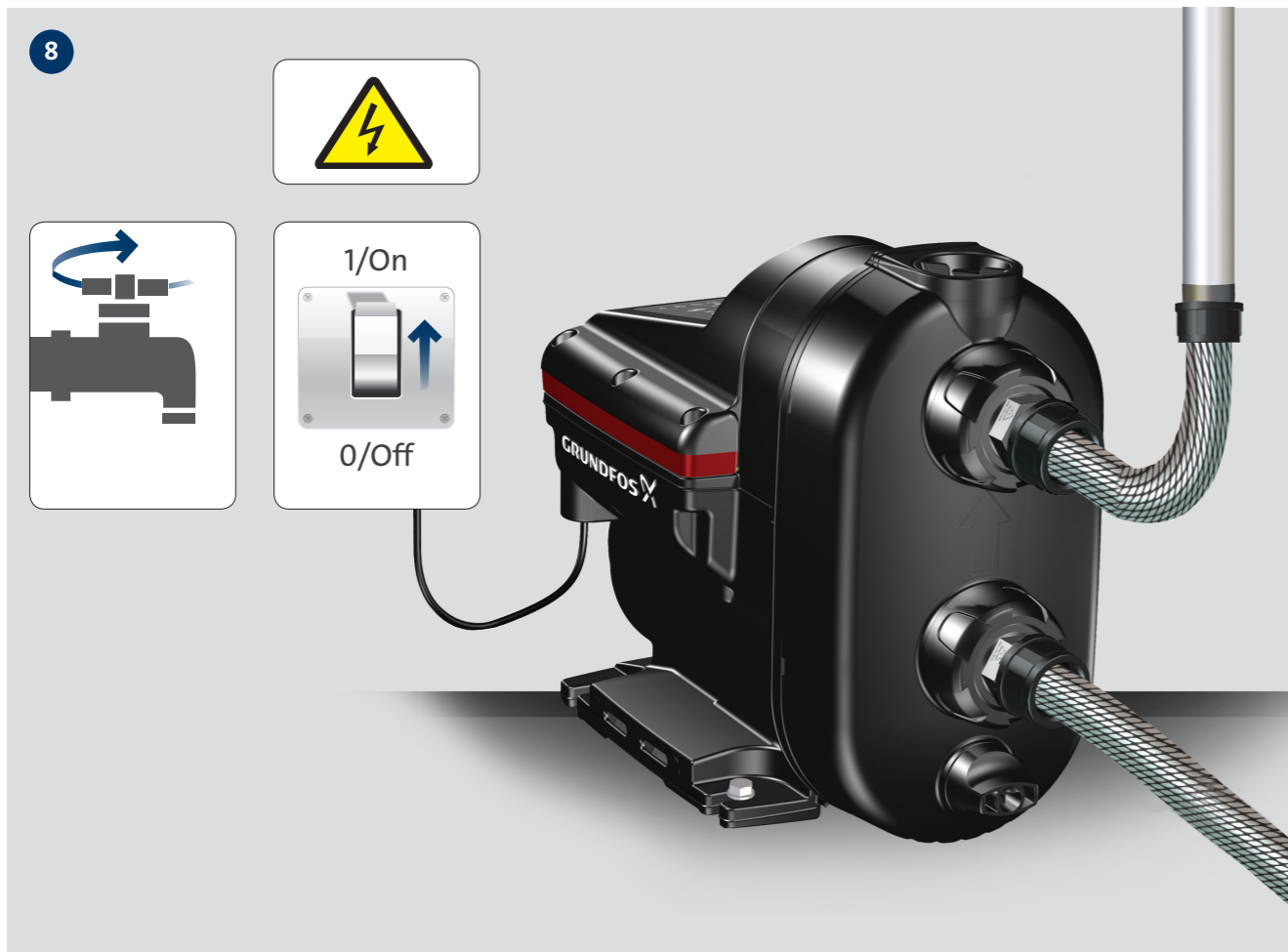
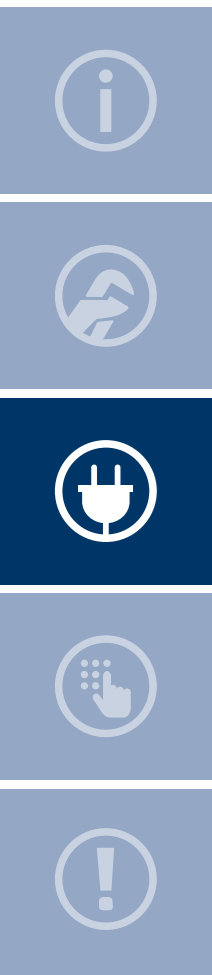

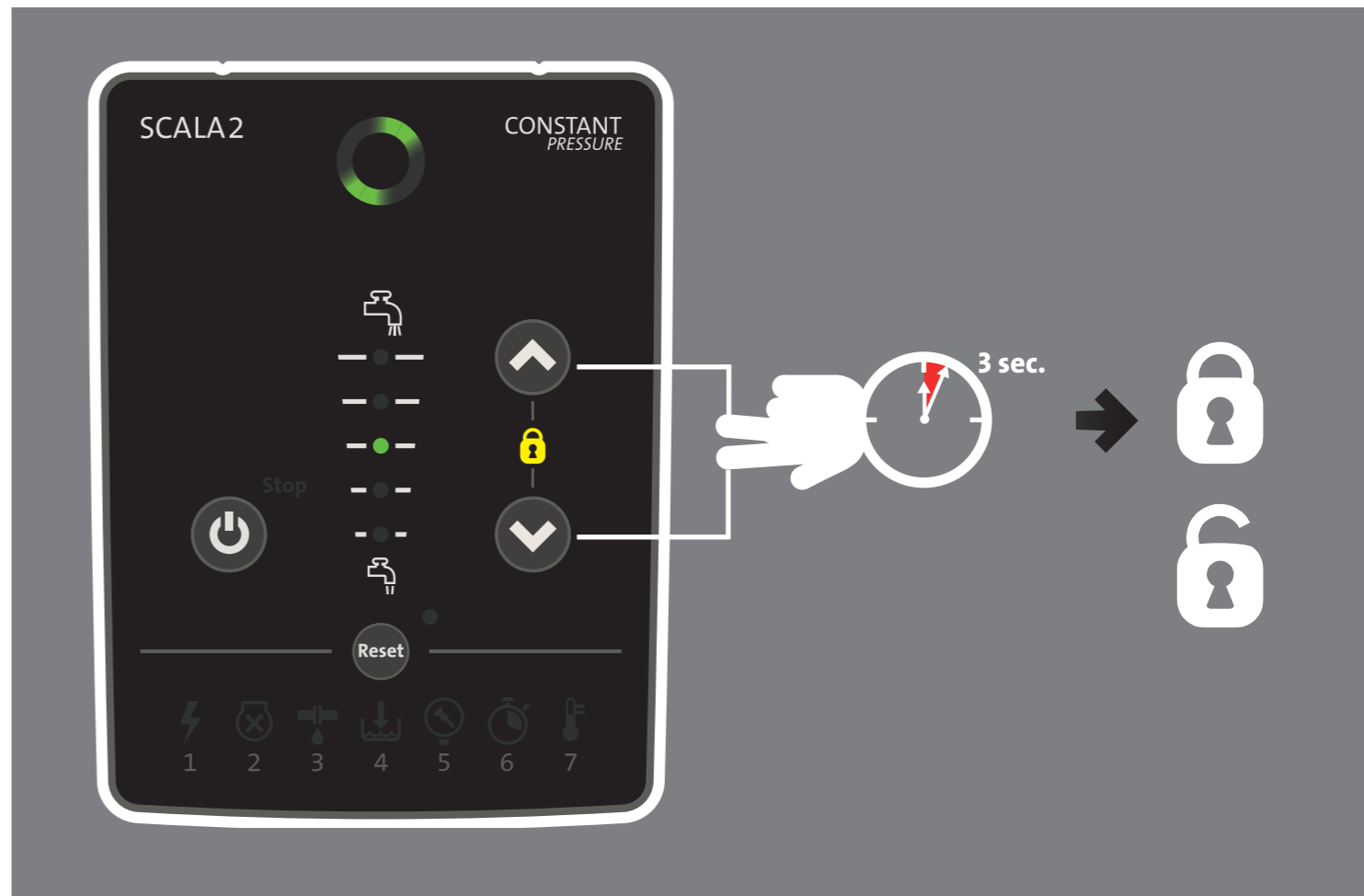
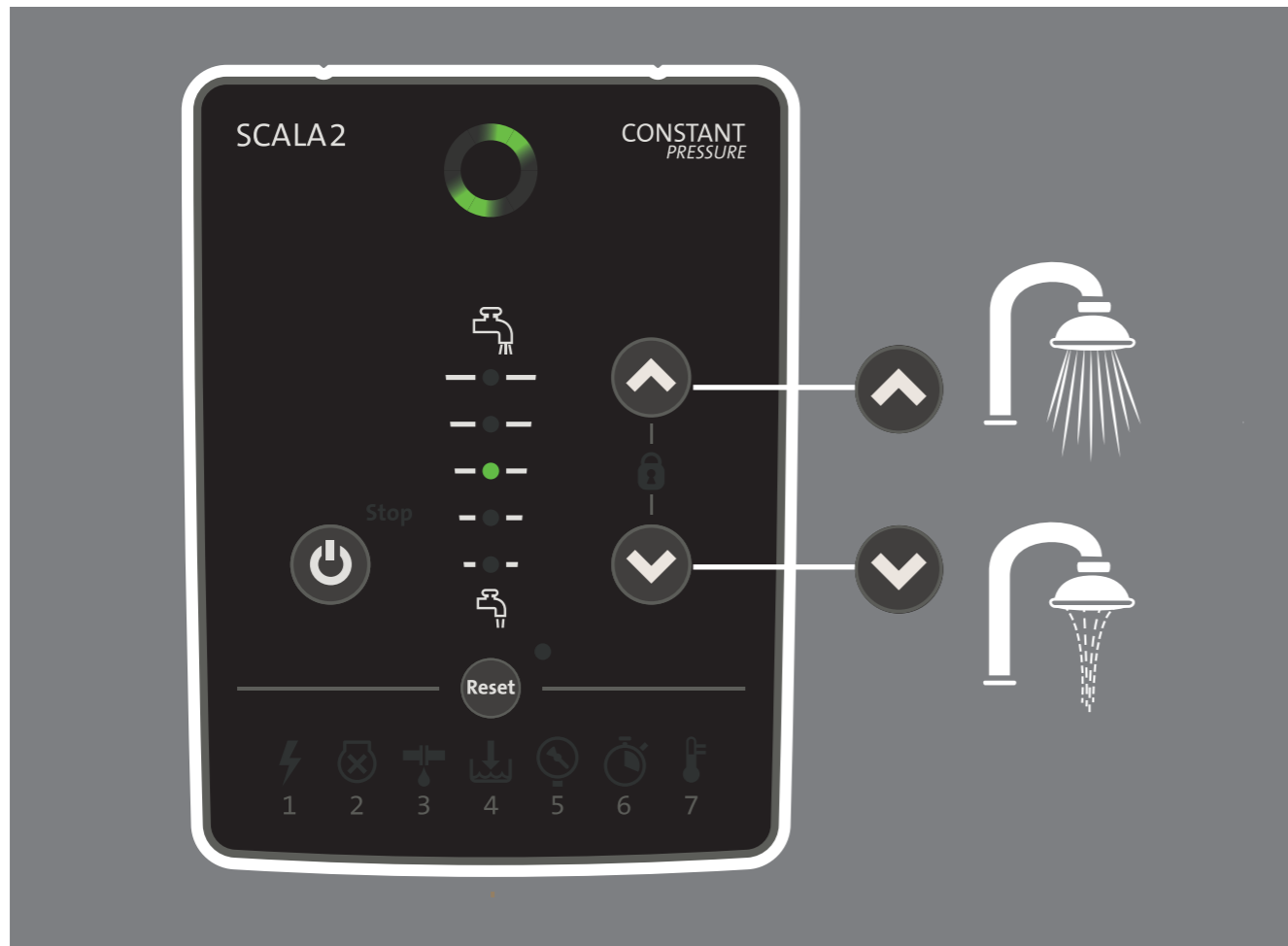
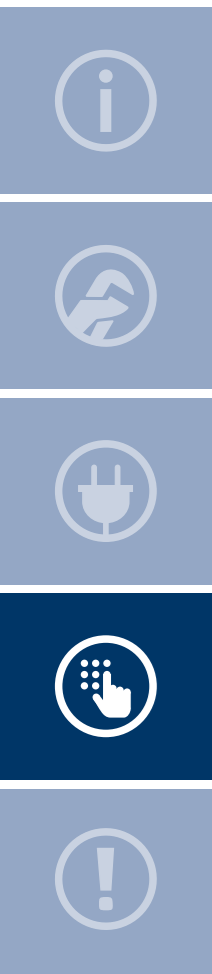

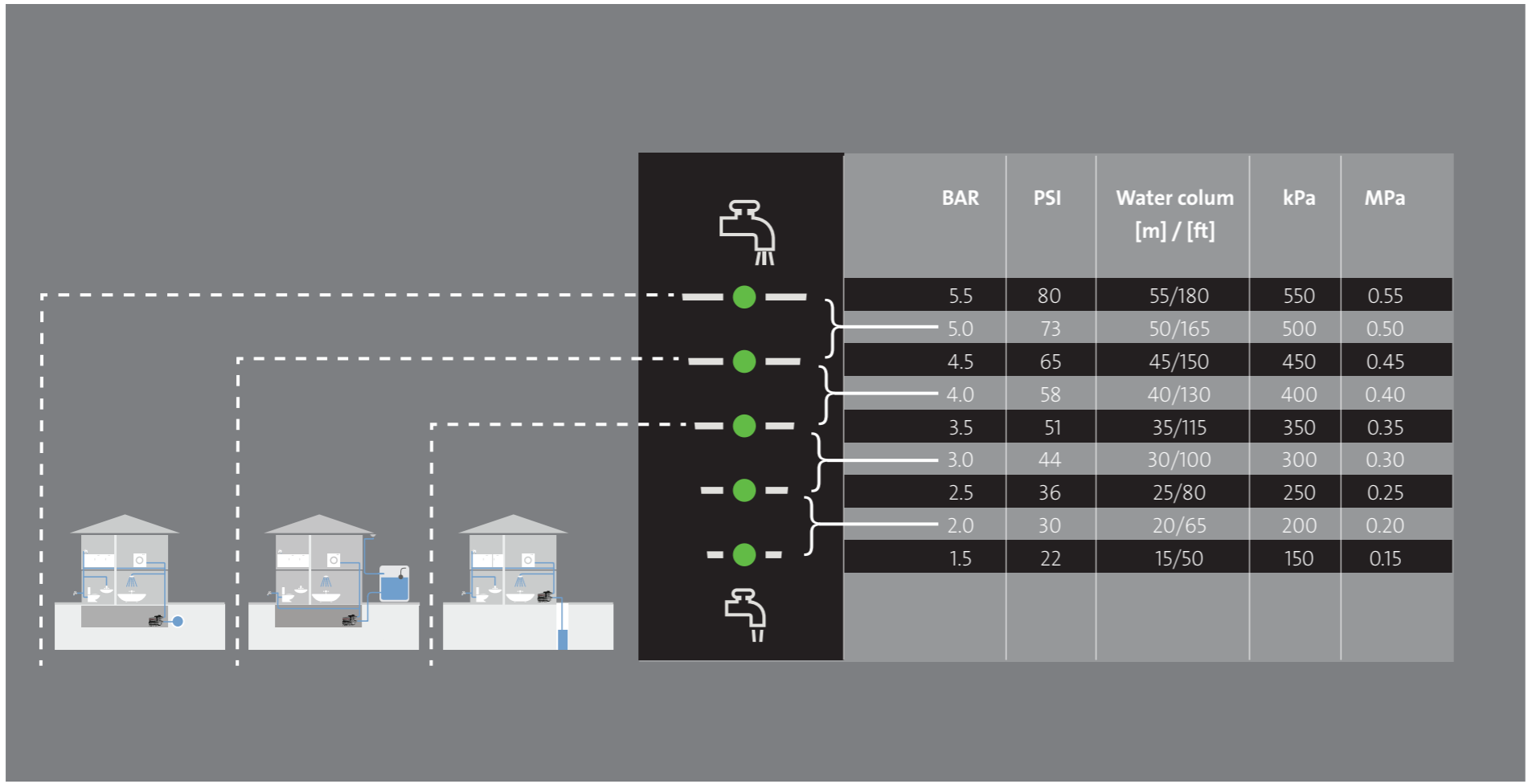
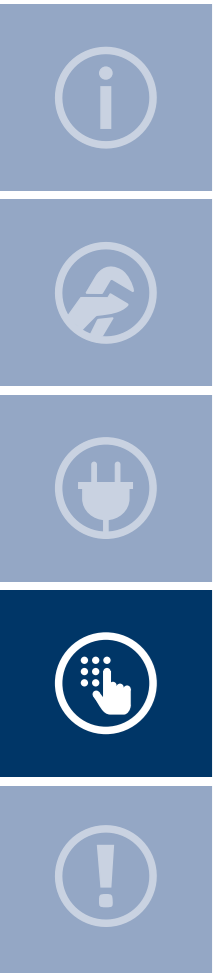

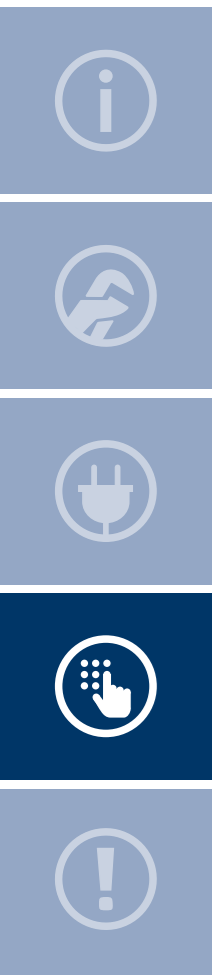

1

1

$U < U_n$
 $U > U_n$

2

2

3 (A)

3

3 (B)

3

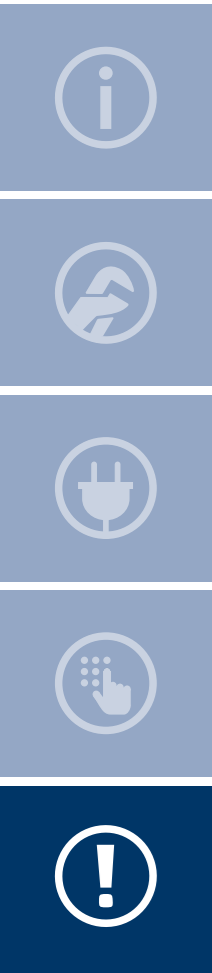

4

SCALA2 CONSTANT PRESSURE

4

5

SCALA2 CONSTANT PRESSURE

5

$p > p_{\text{syst. max.}}$

$P_{\text{set}} > H_{\text{max}}$

6

SCALA2 CONSTANT PRESSURE

6

0.5 hr.

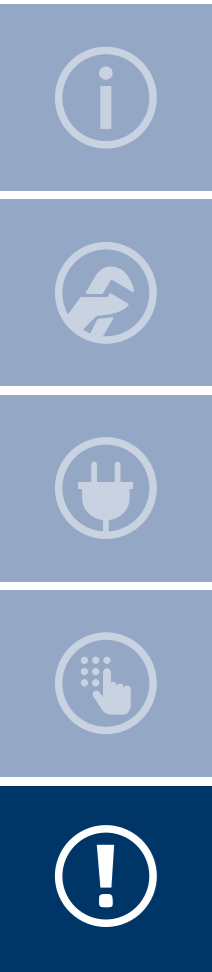

7 (A)

SCALA2 CONSTANT PRESSURE

7

22

7 (B)

SCALA2 CONSTANT PRESSURE

7

23

GRUNDFOS X

- 1: Lightning bolt icon (power)
- 2: Shield with X icon (protection)
- 3: Water drop icon (leak)
- 4: Water level icon (water level)
- 5: Hand with arrow icon (manual)
- 6: Alarm clock icon (alarm)
- 7: Thermometer icon (temperature)

net.grundfos.com/qr/i/98880508

23

be think innovate

98501666 0416

ECM: 1183347

GRUNDFOS Holding A/S
Poul Due Jensens Vej 7
DK-8850 Bjerringbro
Tel: +45 87 50 14 00
www.grundfos.com

GRUNDFOS 

The name Grundfos, the Grundfos logo, and be think innovate are registered trademarks owned by Grundfos Holding A/S or Grundfos A/S, Denmark. All rights reserved worldwide.